

DESIGN CRITERIA

4 UL-142 BASE FUEL TANK FOR A GENERAC SD600 IN A FACTORY ENCLOSURE

COASTLINE POWER SOLUTIONS TO PROVIDE THE FOLLOWING:

4,550 GALLON CPS "ENVIROSHIELD ECONOMY" UL 142, FDEP SUBBASE FUEL TANK (EQ# 533):

- CAPACITY BASED ON 96 HOURS @ 41.4GPH (100% LOAD) 3,980 USEABLE GALLONS
- 10GA MILD STEEL PRIMARY TANK, 7GA MILD STEEL SECONDARY TANK
- RUPTURE BASIN WITH FDEP APPROVED LEAK DETECTION SWITCH (MADISON M-7000 EQ#682)
- MECHANICAL FUEL LEVEL GAUGE (KREUGER MODEL H)
- PROVIDE AND INSTALL (1) ROCHESTER SPIRAL TYPE FUEL GAUGE (8680) WITH GENERAC SENDER.
- SUPPLY AND RETURN CONNECTIONS
- 2" FILL WITH LOCKABLE CAP WITH FDEP SPILL CONTAINMENT AND OVERFILL PREVENTION VALVE (MORRISON 9095AA-0200AV EQ#851)
- NORMAL AND EMERGENCY VENT FITTINGS INSTALLED PER UL-142
- LOW LEVEL FUEL ALARM SWITCH (MADISON M-7000 EQ#682) SET @ 35% REMAINING CAPACITY WIRED TO GENERATOR CONTROL PANEL (FINAL TERMINATION TO TERMINAL STRIP TO BE DONE BY INSTALLING TECHNICIAN)
- HIGH LEVEL FUEL ALARM SWITCH (MADISON M-7000 EQ#682) SET @ 90% TANK CAPACITY WIRED TO GENERATOR CONTROL PANEL (FINAL TERMINATION TO TERMINAL STRIP TO BE DONE BY INSTALLING TECHNICIAN)
- CABLE STUB UP OPENING UNDER CIRCUIT BREAKER
- GENERATOR SET TO BE MOUNTED ON TANK FLANGES
- 2 LIFTING POINTS PER SIDE (4 TOTAL) FOR LIFTING GENERATOR SET, ENCLOSURE AND TANK (EMPTY)
- TANK COATED WITH TWO PART EPOXY PRIMER AND PAINTED GLOSS BLACK.

SHIP UNDER VACUUM:

- TANK SEALED AND SHIPPED UNDER VACUUM PER FLORIDA ADMINISTRATIVE CODE CHAPTER 62-762 AND NFPA30
- TANK VACUUM TO BE VERIFIED AND DOCUMENTED PER NFPA-30 IMMEDIATELY UPON RECEIPT AND PLACEMENT AT THE JOB SITE.

SYSTEM INTEGRATION:

- UNLOAD CUSTOMER SUPPLIED GENERATOR SET AND COMPONENTS FROM TRUCKS.
- INSTALL GENERATOR TO FUEL TANK BASE.
- PLUMB FUEL TANK TO GENERATOR SET ENGINE.
- PROVIDE FOR SHIP LOOSE 4" X 1/4" NEOPRENE PADDING FOR INSTALLATION BETWEEN TANK AND PAD
- LOAD UNIT ONTO CUSTOMER PROVIDED TRUCKS FOR SHIPMENT.

CUSTOMER TO PROVIDE:

- GENERAC 600KW ENGINE GENERATOR SET PACKAGE WITH FACTORY INSTALLED RADIATOR
- UNIT MOUNTED MAIN LINE CIRCUIT BREAKER
- BATTERY CHARGER

TANK FITTING LEGEND

- F - 2" OVERFILL PREVENTION VALVE - 4" NPT
- G - MECH. FUEL GAUGE - 2" NPT
- D - LEAK DETECTOR [MADISON M-7000 EQ#682] - 2" NPT
- RG- ROCHESTER SPIRAL GAUGE WITH GENERAC SENDER - 2" NPT
- S - FUEL SUPPLY - 2" NPT (W/1" DROP TUBE)
- R - FUEL RETURN - 2" NPT (W/1" DROP TUBE)
- DS - DAYTANK FUEL SUPPLY - 2" NPT W/1" DROP TUBE
- DR - DAYTANK FUEL RETURN - 2" NPT W/1" DROP TUBE
- DB - SPILL BOX DRAIN - 1/2" HALF COUPLING
- V - MAIN VENT - 2" NPT
- SV - SECONDARY EMERGENCY VENT - 8" NPT
- PV - PRIMARY EMERGENCY VENT - 8" NPT
- H - HIGH FUEL LEVEL SENSOR [MADISON M-7000 EQ#682] - 2" NPT
- L - LOW FUEL LEVEL SENSOR [MADISON M-7000] - 2" NPT
- SP - SPARE - 2"NPT
- EP - EQUALIZATION PORT - 2" NPT W/1" DROP TUBE
- VP - SECONDARY VACUUM PORT - 1/2" NPT
- SD - SECONDARY DRAIN PORT - 1" NPT
- PS - FUEL POLISHING SUPPLY - 2" NPT W/1" DROP TUBE
- PR - FUEL POLISHING RETURN - 2" NPT W/1" DROP TUBE
- SS - 4-20ma SENDER - 2"NPT
- DTCS - DAYTANK CONTROL SWITCHES

CPS UL-142 DOUBLE WALL TANK & SPILL CONTAINMENT - [EQ#533]

- *NOTES: 1. THIS IS A STANDARD LEGEND, SOME FITTINGS MAY NOT APPLY
- 2. TANK FITTING SIZES SHOWN ON PLAN ARE OPENING SIZES



1965 BENNETT DRIVE, DELAND, FL. 32724
 PHONE: 386-469-0070 FAX: 386-469-0071
 WEBSITE: WWW.COASTLINEPOWERSOLUTIONS.COM

PROJECT INFORMATION

CUSTOMER: ACF POWER
PROJECT: SOUTH FLORIDA WRF
ESTIMATED SHIPPING WEIGHTS (SEE DRAWINGS FOR SHIPPING DIMENSIONS)
GENSET: 10,778 LBS
TANK/BASEFRAME: 10,500 LBS
ENCLOSURE: 1,758 LBS
COMPONENT CAD DRAWINGS
OK1501E MD600 L2 Enclosure A0001541468 MD 600 Open set

REV:	DESCRIPTION:	DATE:	BY:
1	CHANGED TANK FOOTPRINT PER CUSTOMER REQUEST.	5/19/2022	BAP
REVISIONS			

DRAWN BY:	BAP
REVIEWED BY:	RB/EJ
DATE:	5/11/2022
SCALE:	NTS
PROJECT NUMBER:	20220088

DRAWINGS FOR APPROVAL

APPROVED AS DRAWN
 REVISE AS NOTED

SIGNATURE: _____ DATE: _____
 NAME (PLEASE PRINT): _____
 TITLE: _____

TITLE: DESIGN CRITERIA
 SHEET: 1 OF 5

EXHIBIT F

SHIPPING NOTE:

UNIT TO BE SHIPPED IN TWO PIECES.
 EXTRA TRUCK FOR SHIP LOOSE (IF APPLICABLE)

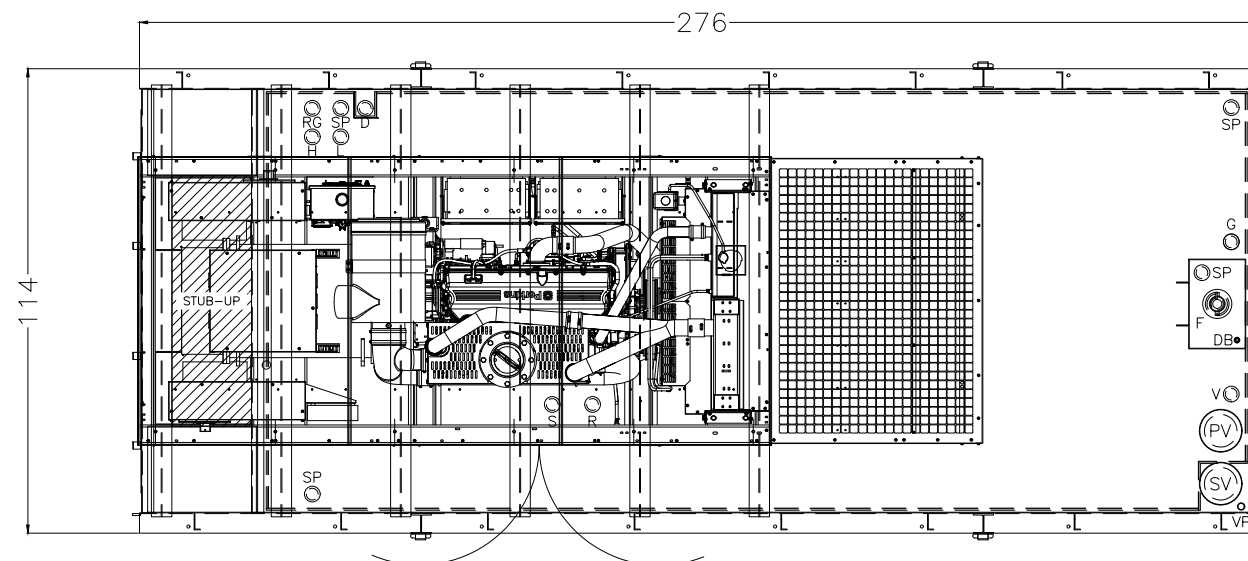

PLAN VIEW

PROJECT INFORMATION

CUSTOMER:	ACF POWER
PROJECT:	SOUTH FLORIDA WRF
ESTIMATED SHIPPING WEIGHTS (SEE DRAWINGS FOR SHIPPING DIMENSIONS)	
GENSET:	10,778 LBS
TANK/BASEFRAME:	10,500 LBS
ENCLOSURE:	1,758 LBS
COMPONENT CAD DRAWINGS	
OK1501E MD600 L2 Enclosure A0001541468 MD 600 Open set	

70.858 OVERALL ENCLOSURE SHIPPING WIDTH

EXHIBIT F

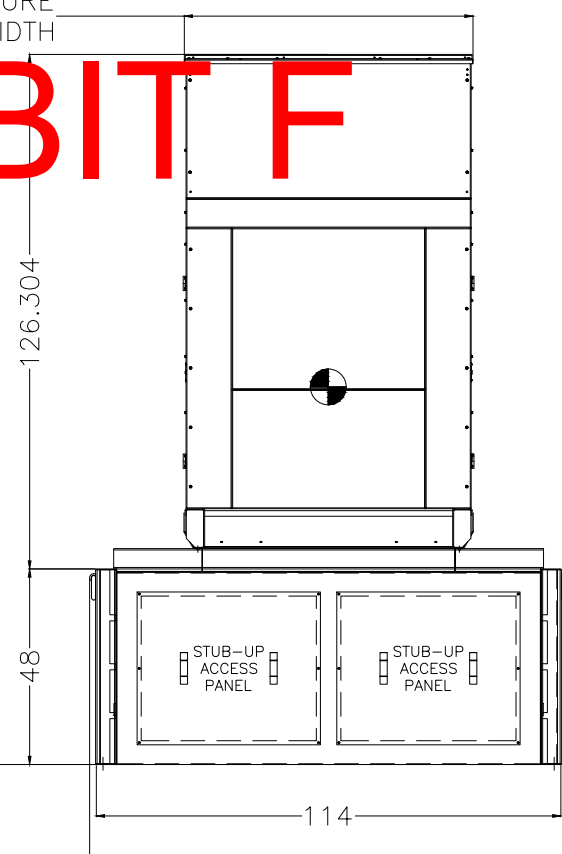

REAR ELEVATION

117.304 OVERALL TANK SHIPPING WIDTH

207.342 OVERALL ENCLOSURE SHIPPING LENGTH

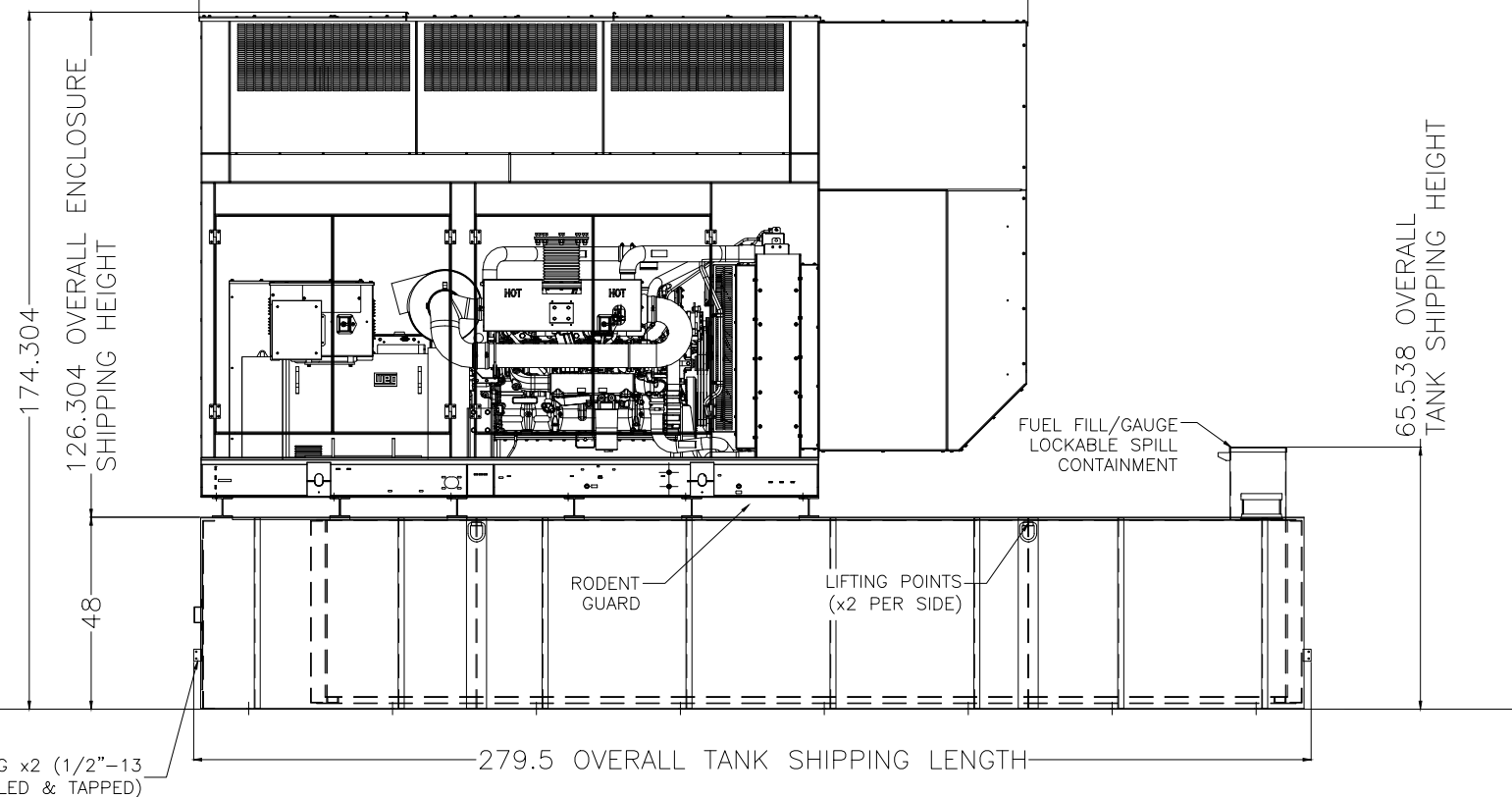

RIGHT SIDE ELEVATION

65.538 OVERALL TANK SHIPPING HEIGHT

REV:	DESCRIPTION:	DATE:	BY:
1	CHANGED TANK FOOTPRINT PER CUSTOMER REQUEST.	5/19/2022	BAP
REVISIONS			

DRAWN BY:	BAP
REVIEWED BY:	RB/EJ
DATE:	5/11/2022
SCALE:	NTS
PROJECT NUMBER:	20220088

DRAWINGS FOR APPROVAL

APPROVED AS DRAWN	<input type="checkbox"/>
REVISE AS NOTED	<input type="checkbox"/>
SIGNATURE: _____	DATE: _____
NAME (PLEASE PRINT): _____	
TITLE: _____	

TITLE: PLAN/ELEVATIONS VIEW

SHEET: 2 OF 5

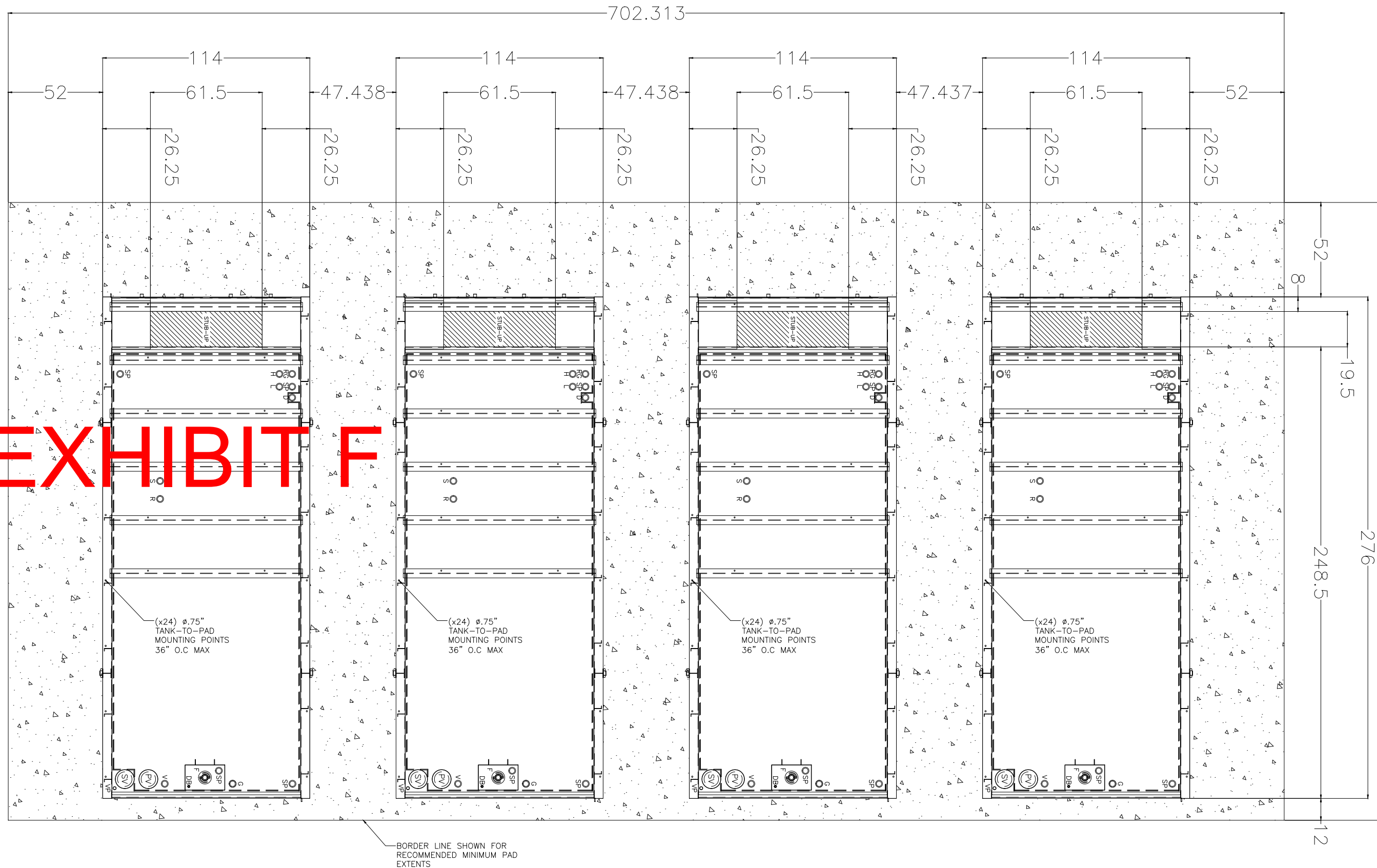

SUGGESTED PAD LAYOUT
(SHOWING ALL FOUR TANKS)

PROJECT INFORMATION

CUSTOMER:	ACF POWER
PROJECT:	SOUTH FLORIDA WRF
ESTIMATED SHIPPING WEIGHTS (SEE DRAWINGS FOR SHIPPING DIMENSIONS)	
GENSET:	10,778 LBS
TANK/BASEFRAME:	10,500 LBS
ENCLOSURE:	1,758 LBS
COMPONENT CAD DRAWINGS	
OK1501E MD600 L2 Enclosure A0001541468 MD 600 Open set	

REV:	DESCRIPTION:	DATE:	BY:
1	CHANGED TANK FOOTPRINT PER CUSTOMER REQUEST.	5/19/2022	BAP
REVISIONS			

DRAWN BY:	BAP
REVIEWED BY:	RB/EJ
DATE:	5/11/2022
SCALE:	NTS
PROJECT NUMBER:	20220088

DRAWINGS FOR APPROVAL	
APPROVED AS DRAWN	<input type="checkbox"/>
REVISE AS NOTED	<input type="checkbox"/>
SIGNATURE: _____	DATE: _____
NAME (PLEASE PRINT): _____	
TITLE: _____	

TITLE:	PAD LAYOUT
SHEET:	3 OF 5

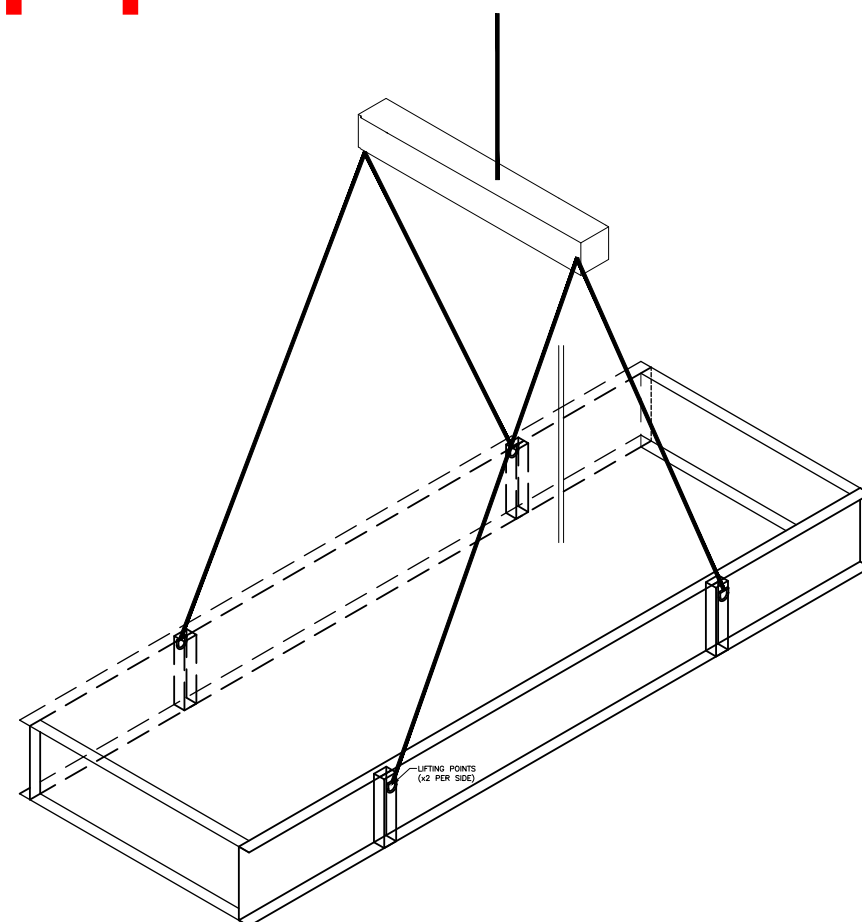
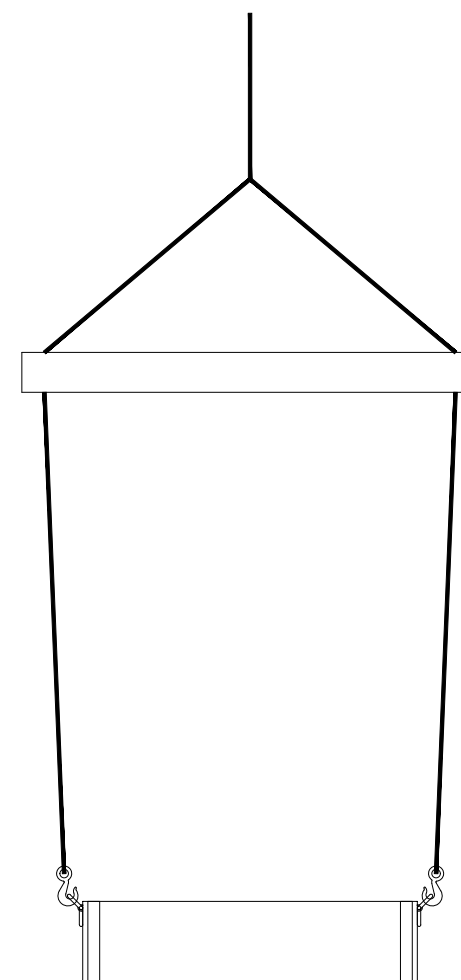
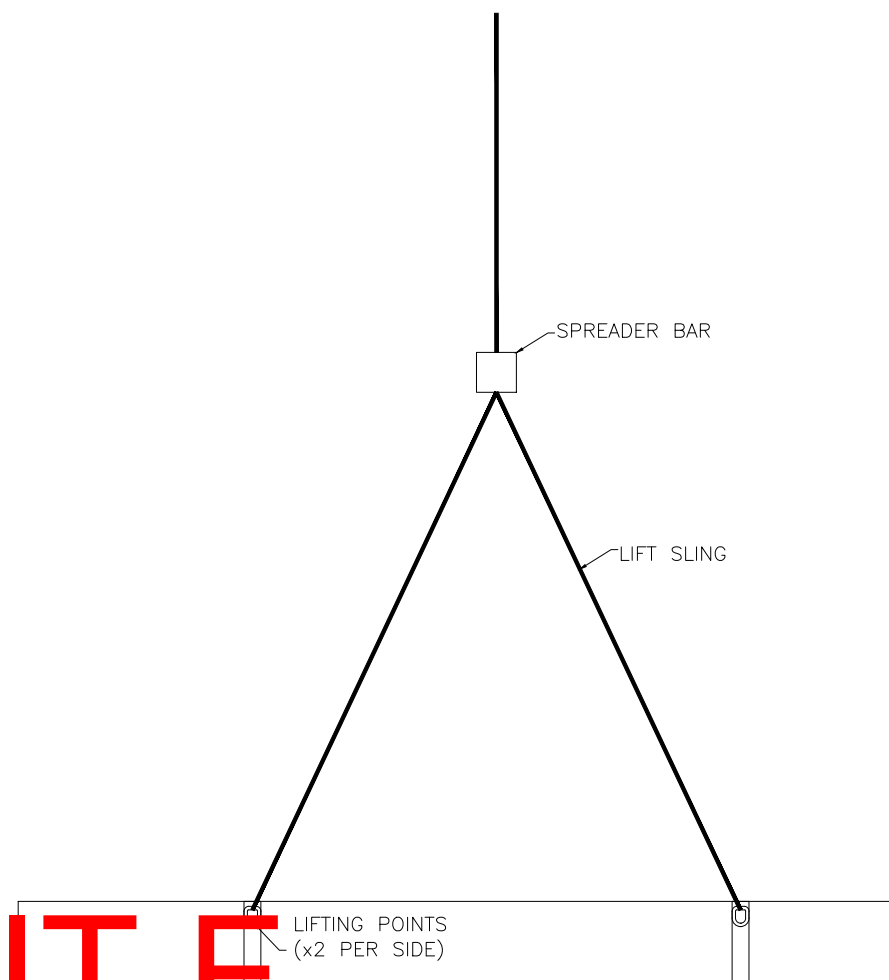

**TANK LIFTING
INSTRUCTION**

NOTE:
RIGGING IS SHOWN FOR ILLUSTRATION
PURPOSES ONLY.
UNIT DESIGN MAY VARY. FINAL RIGGING TO BE
DONE BY A PROFESSIONAL, LICENSED AND
INSURED RIGGING COMPANY.

PROJECT INFORMATION

CUSTOMER:	ACF POWER	
PROJECT:	SOUTH FLORIDA WRF	
ESTIMATED SHIPPING WEIGHTS (SEE DRAWINGS FOR SHIPPING DIMENSIONS)		
GENSET:	10,778 LBS	
TANK/BASEFRAME:	10,500 LBS	
ENCLOSURE:	1,758 LBS	
COMPONENT CAD DRAWINGS		
0K1501E MD600 L2 Enclosure A0001541468 MD 600 Open set		

REV:	DESCRIPTION:	DATE:	BY:
1	CHANGED TANK FOOTPRINT PER CUSTOMER REQUEST.	5/19/2022	BAP
REVISIONS			

DRAWN BY:	BAP
REVIEWED BY:	RB/EJ
DATE:	5/11/2022
SCALE:	NTS
PROJECT NUMBER:	20220088

DRAWINGS FOR APPROVAL	
APPROVED AS DRAWN	<input type="checkbox"/>
REVISE AS NOTED	<input type="checkbox"/>
SIGNATURE: _____	DATE: _____
NAME (PLEASE PRINT): _____	
TITLE: _____	

EXHIBIT F

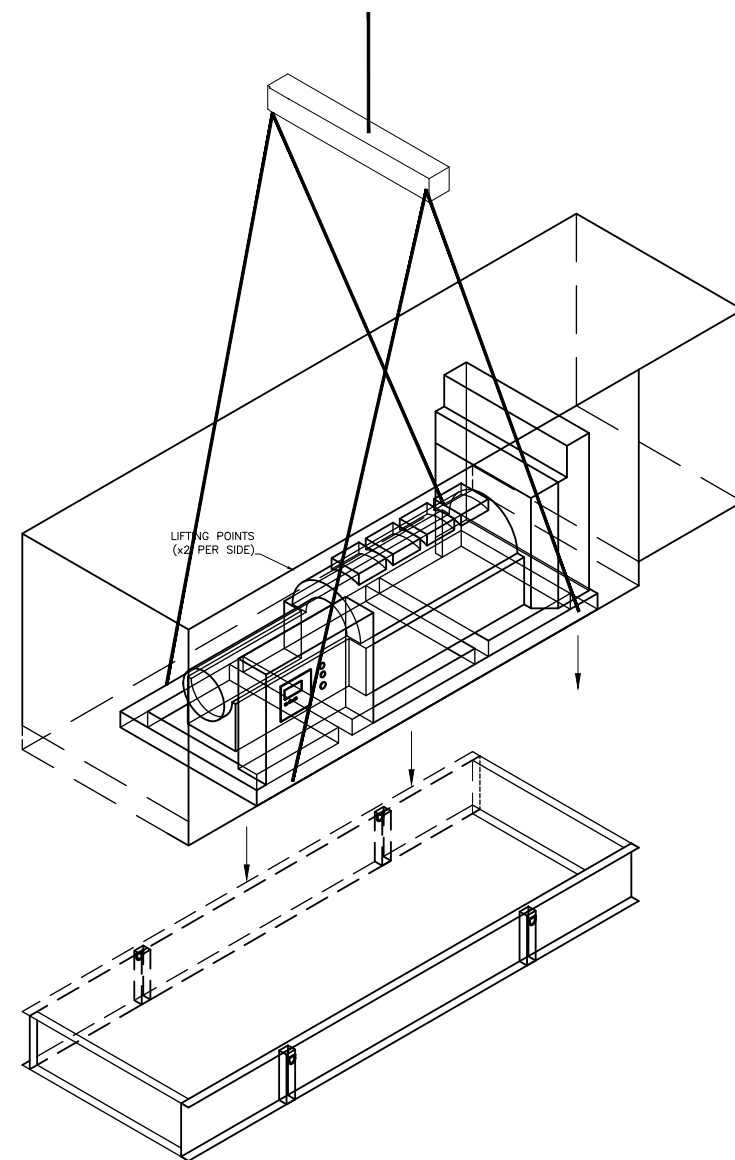
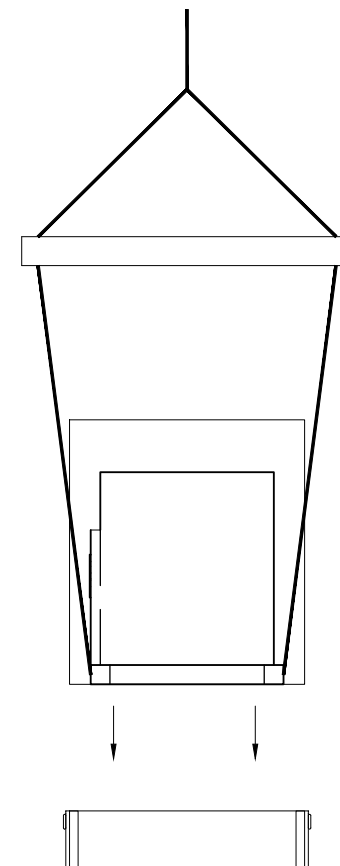
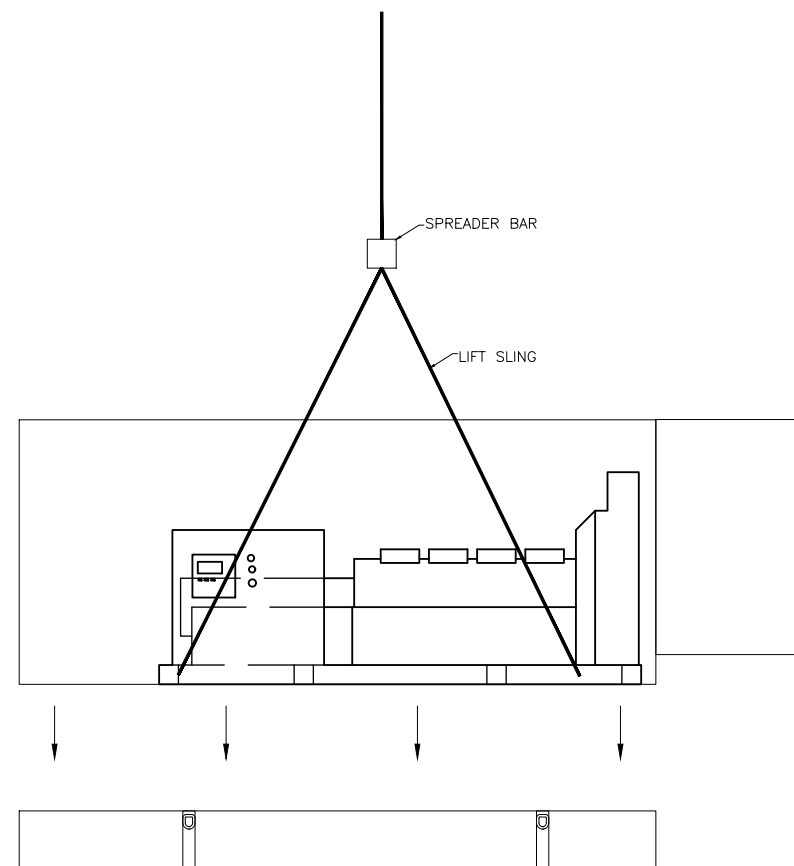

**ENCLOSURE AND GENSET
LIFTING INSTRUCTION**

NOTE:
RIGGING IS SHOWN FOR ILLUSTRATION
PURPOSES ONLY.
UNIT DESIGN MAY VARY. FINAL RIGGING TO BE
DONE BY A PROFESSIONAL, LICENSED AND
INSURED RIGGING COMPANY.

PROJECT INFORMATION

CUSTOMER:	ACF POWER
PROJECT:	SOUTH FLORIDA WRF
ESTIMATED SHIPPING WEIGHTS (SEE DRAWINGS FOR SHIPPING DIMENSIONS)	
GENSET:	10,778 LBS
TANK/BASEFRAME:	10,500 LBS
ENCLOSURE:	1,758 LBS
COMPONENT CAD DRAWINGS	
OK1501E MD600 L2 Enclosure	
A0001541468 MD 600 Open set	

REV:	DESCRIPTION:	DATE:	BY:
1	CHANGED TANK FOOTPRINT PER CUSTOMER REQUEST.	5/19/2022	BAP
REVISIONS			

DRAWN BY:	BAP
REVIEWED BY:	RB/EJ
DATE:	5/11/2022
SCALE:	NTS
PROJECT NUMBER:	20220088

DRAWINGS FOR APPROVAL

APPROVED AS DRAWN
REVISE AS NOTED

SIGNATURE: _____ DATE: _____
NAME (PLEASE PRINT): _____
TITLE: _____

TITLE: TYP. LIFTING DIAGRAM

SHEET: 5 OF 5

EXHIBIT F

DESIGN CRITERIA

1 OSHA COMPLIANT PLATFORMS AND ACCESS STEPS

COASTLINE POWER SOLUTIONS TO PROVIDE THE FOLLOWING:

OSHA COMPLIANT STAIRS AND WALKWAYS:

- (3) SET OF OSHA COMPLIANT STAIRS AND RAILINGS AND WALKWAY WITH RAILINGS: 40" WIDE X 48" TALL (TO BE LOCATED BETWEEN GENERATOR SETS).
- (2) SET OF OSHA COMPLIANT STAIRS AND RAILINGS AND WALKWAY WITH RAILINGS: 40" WIDE X 48" TALL (TO BE LOCATED AT THE END OF THE GENERATOR SETS).
- (1) SET OF OSHA COMPLIANT WALKWAY: 40" WIDE X 48" TALL.
- RAILINGS TO BE CONSTRUCTED OF 1 1/2" ALUMINUM TUBE.
- STEPS AND WALKWAYS CONSTRUCTED OF EXTRUDED ALUMINUM
- LEVELING PADS
- STAIRS SET TO BE SHIPPED LOOSE AND ASSEMBLED ON SITE BY OTHERS
- DESIGNED TO WORK WITH (4) SD600 WITH (3) SETS OF CONJOINING PLATFORMS, (2) SETS OF END PLATFORMS AND A FULL LENGTH SET OF PLATFORMS ACROSS THE REAR OF ALL THE UNITS.

SYSTEM INTEGRATION:

- LOAD UNIT ONTO CUSTOMER PROVIDED TRUCKS FOR SHIPMENT.

EXHIBIT F

SHIPPING NOTE:

UNIT TO BE SHIPPED IN ONE PIECE.



1965 BENNETT DRIVE, DELAND, FL. 32724
 PHONE: 386-469-0070 FAX: 386-469-0071
 WEBSITE: WWW.COASTLINEPOWERSOLUTIONS.COM

PROJECT INFORMATION	
CUSTOMER:	ACF POWER
PROJECT:	SOUTH FLORIDA WRF S&P
ESTIMATED SHIPPING WEIGHTS (SEE DRAWINGS FOR SHIPPING DIMENSIONS)	
GENSET:	10,778 LBS
TANK/BASEFRAME:	11,600 LBS
ENCLOSURE:	1,758 LBS
COMPONENT CAD DRAWINGS	
0K1501E MD600 L2 Enclosure A0001541468 MD 600 Open set STAIRS AND PLATFORM WEIGHT TBD	

REV:	DESCRIPTION:	DATE:	BY:

DRAWN BY:	BAP
REVIEWED BY:	RB/EJ
DATE:	5/11/2022
SCALE:	NTS
PROJECT NUMBER:	20220086

DRAWINGS FOR APPROVAL	
APPROVED AS DRAWN	<input type="checkbox"/>
REVISE AS NOTED	<input type="checkbox"/>
SIGNATURE: _____	DATE: _____
NAME (PLEASE PRINT): _____	
TITLE: _____	

TITLE:	DESIGN CRITERIA
SHEET:	1 OF 3

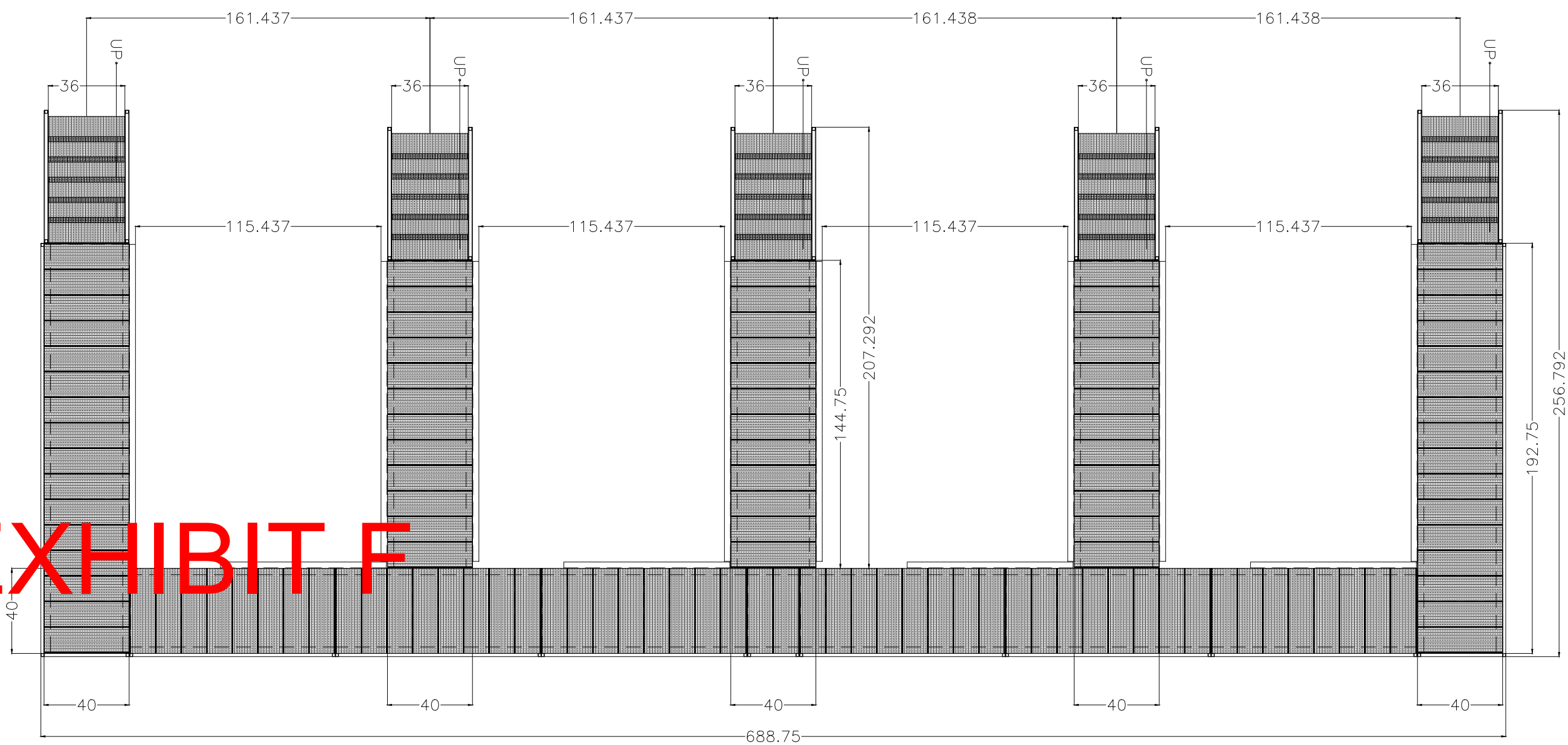

PLAN VIEW (WITHOUT FUEL TANKS)
REFERENCE SUBMITTAL #20220088-S REV1 FOR TANK INFORMATION

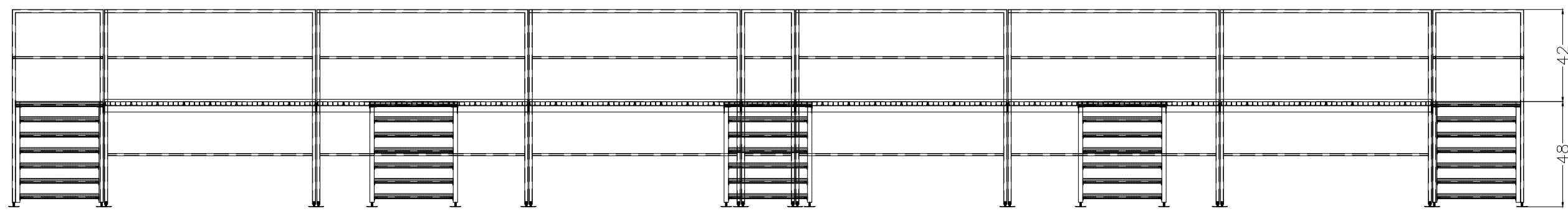

INTAKE END VIEW (WITHOUT FUEL TANKS)
REFERENCE SUBMITTAL #20220088-S REV1 FOR TANK INFORMATION

PROJECT INFORMATION	
CUSTOMER:	ACF POWER
PROJECT:	SOUTH FLORIDA WRF S&P
ESTIMATED SHIPPING WEIGHTS (SEE DRAWINGS FOR SHIPPING DIMENSIONS)	
GENSET:	10,778 LBS
TANK/BASEFRAME:	11,600 LBS
ENCLOSURE:	1,758 LBS
COMPONENT CAD DRAWINGS	
0K1501E MD600 L2 Enclosure A0001541468 MD 600 Open set STAIRS AND PLATFORM WEIGHT TBD	

REV:	DESCRIPTION:	DATE:	BY:
REVISIONS			

DRAWN BY:	BAP
REVIEWED BY:	RB/EJ
DATE:	5/11/2022
SCALE:	NTS
PROJECT NUMBER:	20220086

DRAWINGS FOR APPROVAL	
APPROVED AS DRAWN	<input type="checkbox"/>
REVISE AS NOTED	<input type="checkbox"/>
SIGNATURE: _____	DATE: _____
NAME (PLEASE PRINT): _____	TITLE: _____

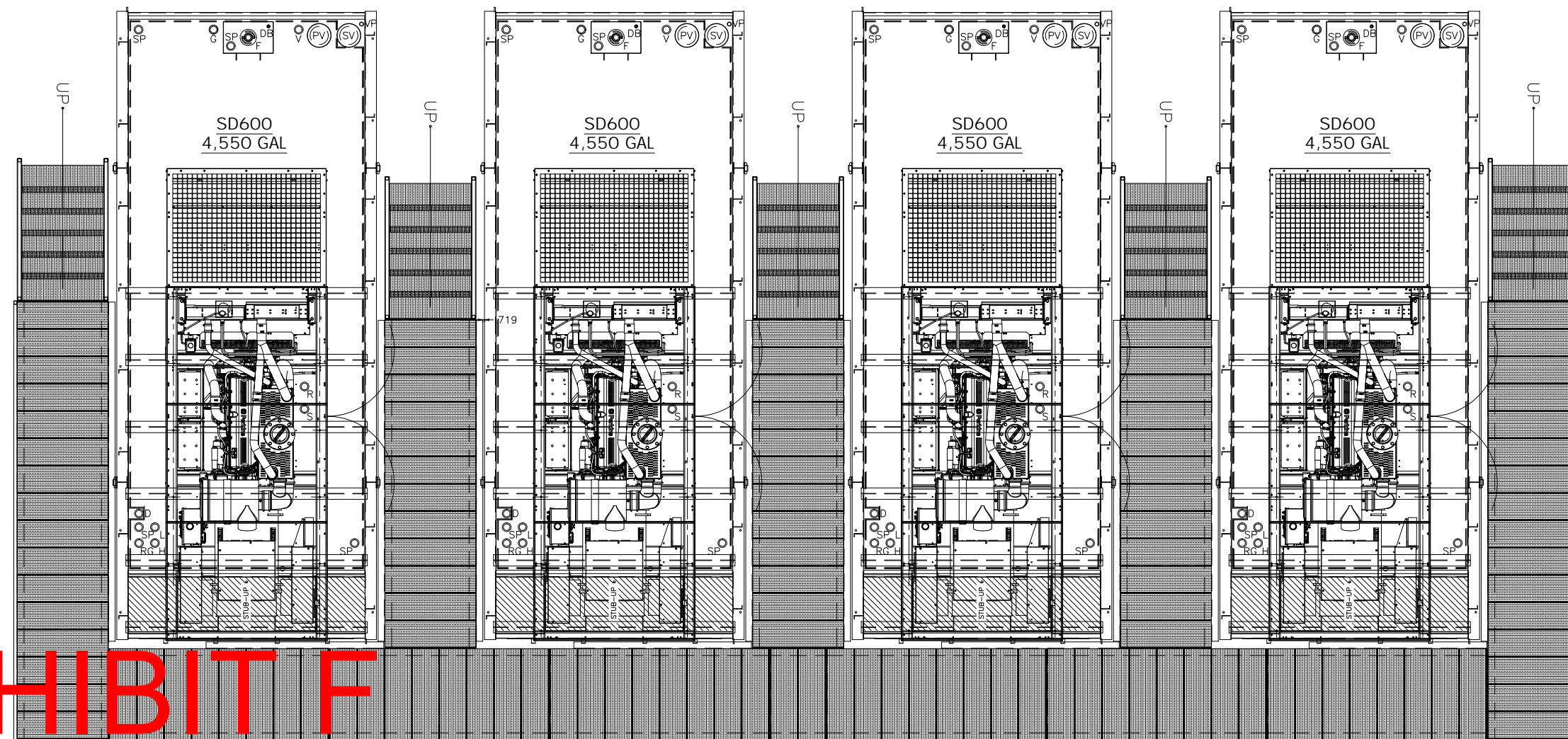
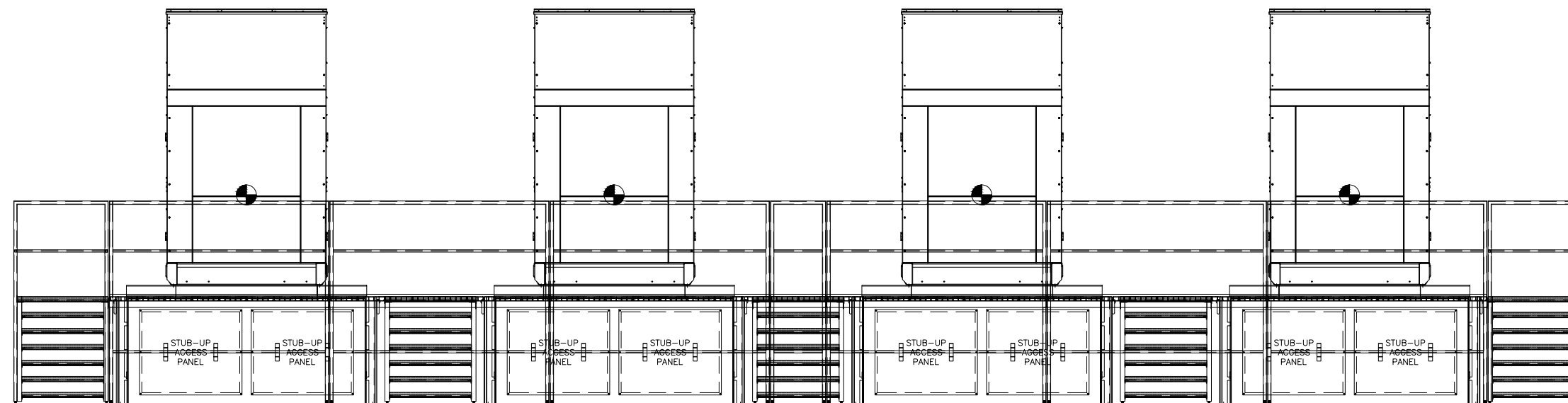

EXHIBIT F

PLAN VIEW (WITHOUT FUEL TANKS)
REFERENCE SUBMITTAL #20220088-S REV1 FOR TANK INFORMATION



INTAKE END VIEW (WITHOUT FUEL TANKS)
REFERENCE SUBMITTAL #20220088-S REV1 FOR TANK INFORMATION

PROJECT INFORMATION

CUSTOMER:	ACF POWER
PROJECT:	SOUTH FLORIDA WRF S&P
ESTIMATED SHIPPING WEIGHTS (SEE DRAWINGS FOR SHIPPING DIMENSIONS)	
GENSET:	10,778 LBS
TANK/BASEFRAME:	11,600 LBS
ENCLOSURE:	1,758 LBS
COMPONENT CAD DRAWINGS	
OK1501E MD600 L2 Enclosure A0001541468 MD 600 Open set STAIRS AND PLATFORM WEIGHT TBD	

REV:	DESCRIPTION:	DATE:	BY:

DRAWN BY:	BAP
REVIEWED BY:	RB/EJ
DATE:	5/11/2022
SCALE:	NTS
PROJECT NUMBER:	20220086

DRAWINGS FOR APPROVAL	
APPROVED AS DRAWN <input type="checkbox"/>	REVISE AS NOTED <input type="checkbox"/>
SIGNATURE: _____	DATE: _____
NAME (PLEASE PRINT): _____	
TITLE: _____	