

LOT COVERAGE SUMMARY

| BUILDING | AREA (AC) |
|---------------------------|-------------|
| MAIN BUILDING | 3.70 |
| EXISTING TELFORD BUILDING | 0.75 |
| TOTAL | 4.45 |

TOTAL MAIN CAMPUS AREA: 13.72 Ac. (597,643 SQFT)
 MAXIMUM LOT COVERAGE (by all buildings): 45% of Main Campus area: 6.17Ac. (268,939 SQFT)
 PROPOSED LOT COVERAGE: 4.45AC / 13.72AC = 32.4%
 EXISTING LOT COVERAGE OF 32.4% IS LESS THAN THE MAXIMUM ALLOWED LOT COVERAGE OF 45.0%

**NCH DOWNTOWN NAPLES HOSPITAL
 MAIN CAMPUS
 EXISTING LOT COVERAGE
 ATTACHMENT C-5**

This item has been digitally signed and sealed by W. Terry Cole, PE, on 11/29/2023 using a Digital Signature.
 Printed copies of this document are not considered signed and sealed and the signature must be verified on any electronic copies.

PREPARED BY :
H M
HOLE MONTES
 ENGINEERS-PLANNERS-SURVEYORS
 Professional Registration No.1772
 Naples - Fort Myers - Venice - Englewood

| | | | |
|--------------------------------------|---|--------------------------------------|------------------------------|
| REVISIONS LETTER _____ DATE _____ | THESE DRAWINGS ARE NOT APPROVED FOR CONSTRUCTION UNLESS SIGNED BELOW: DATE _____ | REFERENCE NO. SOUTH CAMPUS | DRAWING NO. 5097-1 |
| | PROJECT NO. 2023.017 | SHEET NO. 1 OF 2 | |

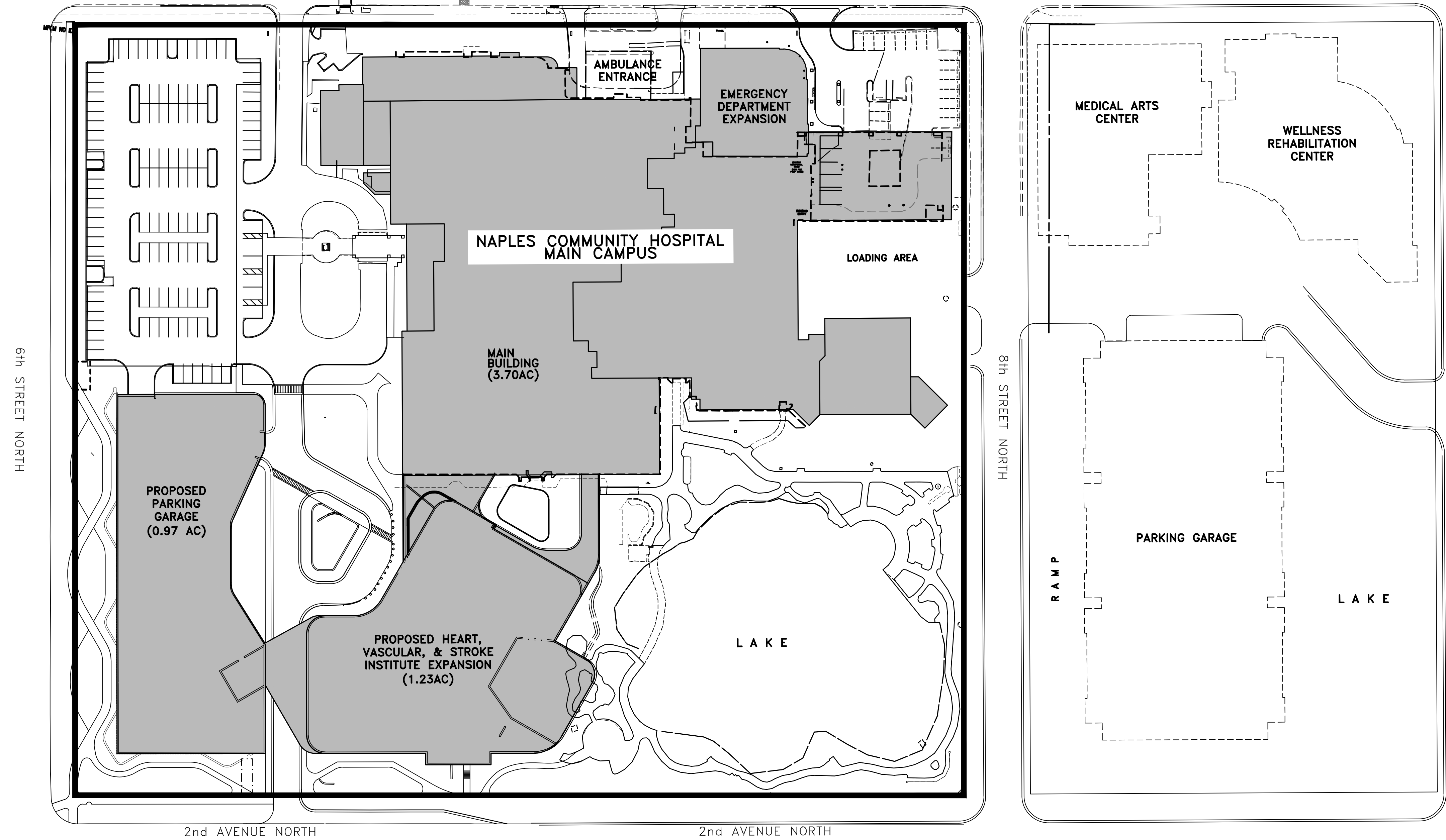
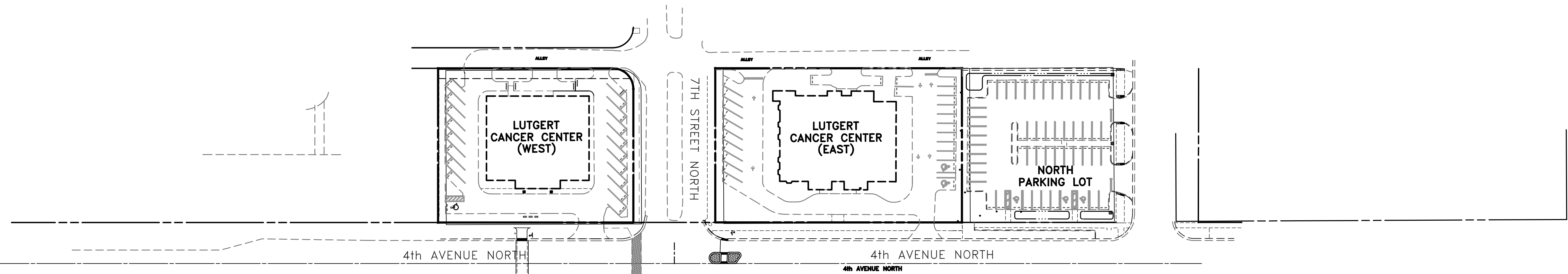

LOT COVERAGE SUMMARY

| BUILDING | AREA (AC) |
|-----------------------------------|---------------|
| MAIN BUILDING | 3.70 |
| PROPOSED PARKING GARAGE | 0.97 |
| PROPOSED HEART INSTITUTE BUILDING | 1.23 |
| TOTAL | 5.90AC |

TOTAL MAIN CAMPUS AREA: 13.72 Ac. (597,643 SQFT)
 MAXIMUM LOT COVERAGE (by all buildings): 45% of Main Campus area: 6.17Ac. (268,939 SQFT)
 PROPOSED LOT COVERAGE: 5.90AC / 13.72AC = 43.0%
 PROPOSED LOT COVERAGE OF 43.0% IS LESS THAN THE MAXIMUM ALLOWED LOT COVERAGE OF 45.0%

**NCH DOWNTOWN NAPLES HOSPITAL
 MAIN CAMPUS
 PROPOSED LOT COVERAGE
 ATTACHMENT C-5**

PREPARED BY :
H M
HOLE MONTES
 ENGINEERS-PLANNERS-SURVEYORS
 Professional Registration No.1772
 Naples - Fort Myers - Venice - Englewood

| | | | | | |
|--|-----------|------|--|--------------------------------------|------------------------------|
| | REVISIONS | DATE | THESE DRAWINGS ARE NOT APPROVED FOR CONSTRUCTION UNLESS SIGNED BELOW: _____ DATE _____ | REFERENCE NO. SOUTH CAMPUS | DRAWING NO. 5032-1 |
| | LETTER | DATE | PROJECT NO. 2023.017 | SHEET NO. 2 OF 2 | |

H:\2023\2023017\DW\EXHIBITS\Land Use\South Campus with topodwg Tab: PARKING Nov. 29, 2023 - 1:09pm. Plotted by: Corrett@robawald

NOT SOUTH CAMPUS 2000.131 (2002.060)