

**LEGEND**

- PROPOSED PAVED SURFACE
- STANDARD CONCRETE SECTION
- ADA PRECAST PAVERS (SEE LANDSCAPE PLANS FOR DETAILS)
- PERVIOUS TURF BLOCK
- DRAINAGE INLET
- PROPOSED SIGN LOCATION

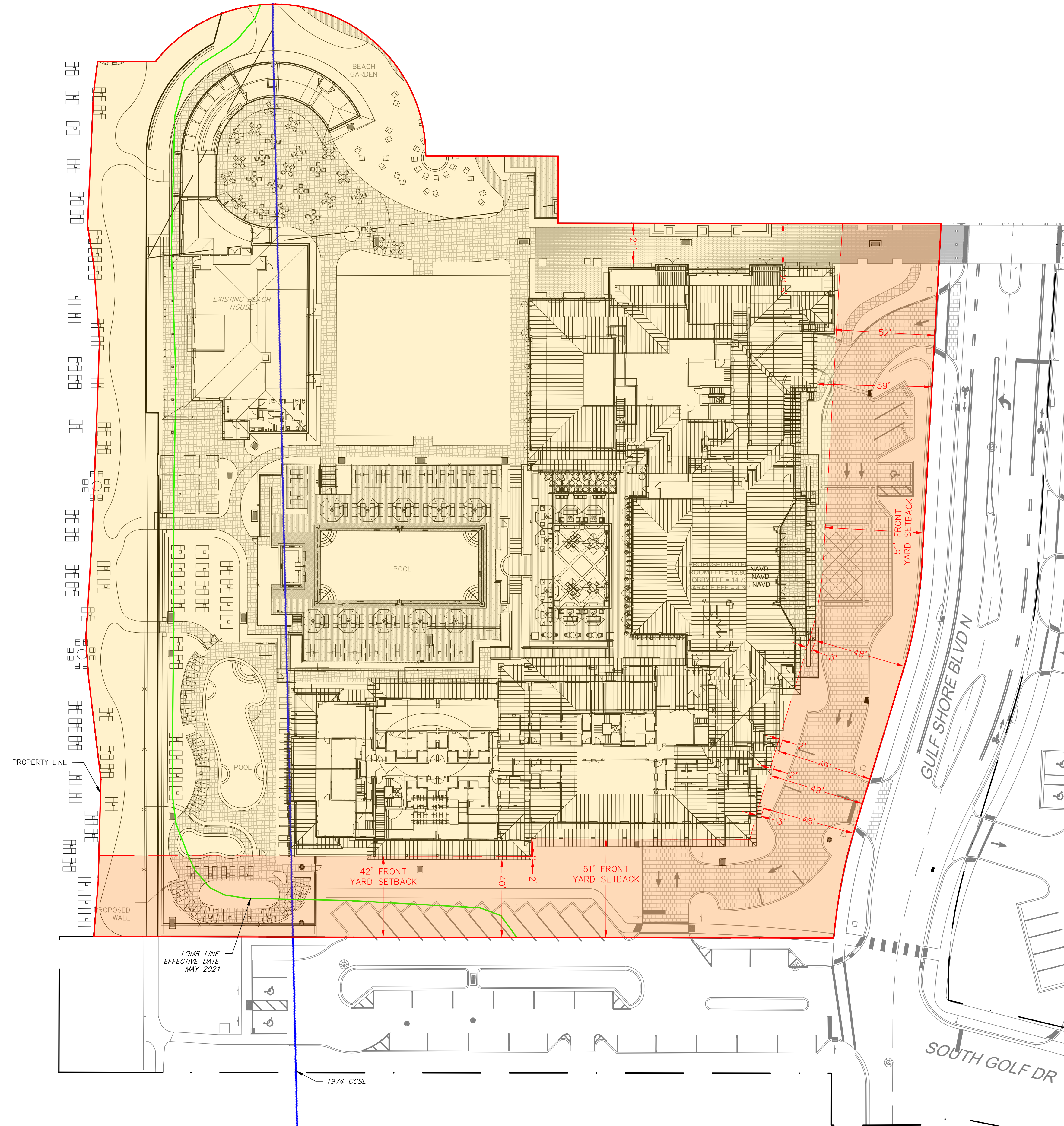

- CLIENT**  
 NAPLES PROPERTY HOLDING COMPANY, LLC  
 225 EAST CAMELBACK ROAD, STE 225, PALM BEACH, FL 33480  
 T: 561.559.3845
- DESIGN ARCHITECT**  
 HART HOMERSON  
 10 E. 40TH STREET, NEW YORK, NY 10018  
 T: 212.683.5631
- ARCHITECT OF RECORD**  
 O'DONNELL, DANHOFF AND PARTNERS ARCHITECTS INC.  
 2432 HOLLYWOOD BLVD, HOLLYWOOD, FL 33020  
 T: 954.518.0833
- STRUCTURAL ENGINEER**  
 DESIMONE CONSULTING ENGINEERS  
 800 BROCKHILL AVENUE #800, MIAMI, FL 33171  
 T: 305.441.0755
- MEP/FPF ENGINEER**  
 EXP SERVICES  
 2801 WESTHALL LANE, MAITLAND, FL 32751  
 T: 407.880.0988
- CIVIL, TRAFFIC & PARKING ENGINEER**  
 DAVIDSON ENGINEERING  
 4365 ROAD ROAD, SUITE 201, NAPLES, FL 34104  
 T: 239.434.6900
- COASTAL ENGINEER**  
 HANSTON & MOORE  
 5879 STRAND COURT, NAPLES, FL 34110  
 T: 239.584.2029
- LANDSCAPE ARCHITECT**  
 HART HOMERSON  
 10 E. 40TH STREET, NEW YORK, NY 10018  
 T: 212.683.5631
- LIGHTING DESIGNER**  
 KGM ARCHITECTURAL LIGHTING  
 307 7TH AVENUE, SUITE 2308, NEW YORK, NY 10001  
 T: 212.684.4166
- LOGISTICS CONSULTANT**  
 LECK, HATFIELD & INC  
 216 S. JEFFERSON STREET, SUITE LL2, CHICAGO, IL 60661  
 T: 616.793.8221
- LOW VOLTAGE CONSULTANT**  
 ENGINEERING PLUS  
 9016 HERITAGE PKWY, SUITE 1000, WOODBRIDGE, IL 60097  
 T: 630.786.4200
- FOOD SERVICE & LAUNDRY CONSULTANT**  
 THE MARSHALL ASSOCIATES INC  
 3000 DANVILLE BLVD, SUITE F344, ALAMO, CA 94507  
 T: 415.671.0200
- INTERIOR DESIGNER**  
 CHAMPANELLE DESIGN  
 115 BROADWAY 2ND FLOOR, NEW YORK, NY 10006  
 T: 212.867.8900
- POOL CONSULTANT**  
 MARTIN AZARIJC DESIGN & ENGINEERING  
 189 SOUTH ORANGE AVE, SUITE 1220, ORLANDO, FL 32801  
 T: 407.588.0503
- LIFE SAFETY / ADA CONSULTANT**  
 SLS CONSULTING INC  
 200 PALERMO AVE, CORAL GABLES, FL 33134  
 T: 888.224.9911

THIS ITEM HAS BEEN ELECTRONICALLY SIGNED AND SEALED BY  
 KURT DANHOF LICENSE NUMBER A02099642 USING A DIGITAL  
 SIGNATURE AND DATE. PRINTED COPIES OF THIS DOCUMENT  
 ARE NOT CONSIDERED SIGNED AND SEALED AND SIGNATURE  
 MUST BE VERIFIED ON ANY ELECTRONIC COPIES.

**odo**  
 ARCHITECTURE AND DESIGN  
 A02099996  
 2432 HOLLYWOOD BLVD, HOLLYWOOD, FL 33020  
 T: 954.518.0833 | F: 954.518.0131  
 www.odarchitects.com

**PROJECT**  
**NAPLES BEACH HOTEL & GOLF CLUB**  
 851 GULF SHORE BOULEVARD NORTH  
 NAPLES, FL 34102

**REVISIONS**

05/10/2021 FINAL DRG SUBMISSION	



**SCALE: 1:30**  
 NOTE: THIS DRAWING IS 24"X36". DO NOT SCALE DRAWINGS.  
 DATE:  
 STARTED BY:  
 DRAWING TITLE:

**BEACH HOTEL OVERHANG SETBACK EXHIBIT (CIVIL)**

SHEET NO.  
**EXH-SW2**

Z:\Active Projects\NAPLES BEACH HOTEL-NBHA Site Civil\Sheets\Files - FDEP ERP #3 To Beachside\Exhibits\SETBACK EXHIBIT\OVERHANG SETBACK EXHIBIT.dwg (ERP-SP3 5-C-20.03) aaron.davidson Jun 18, 2021 - 1:20pm

