

PHONE 262-7022

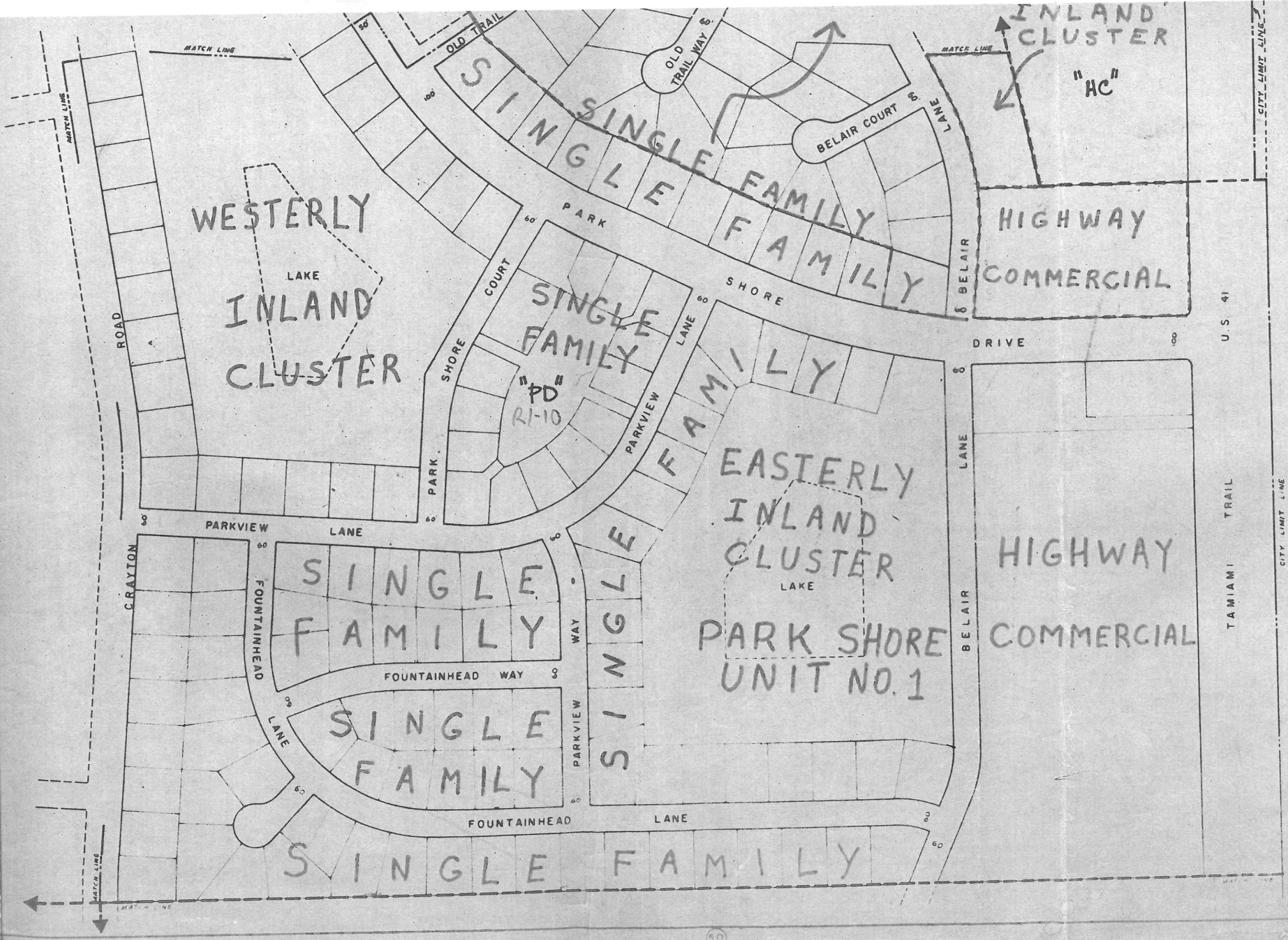

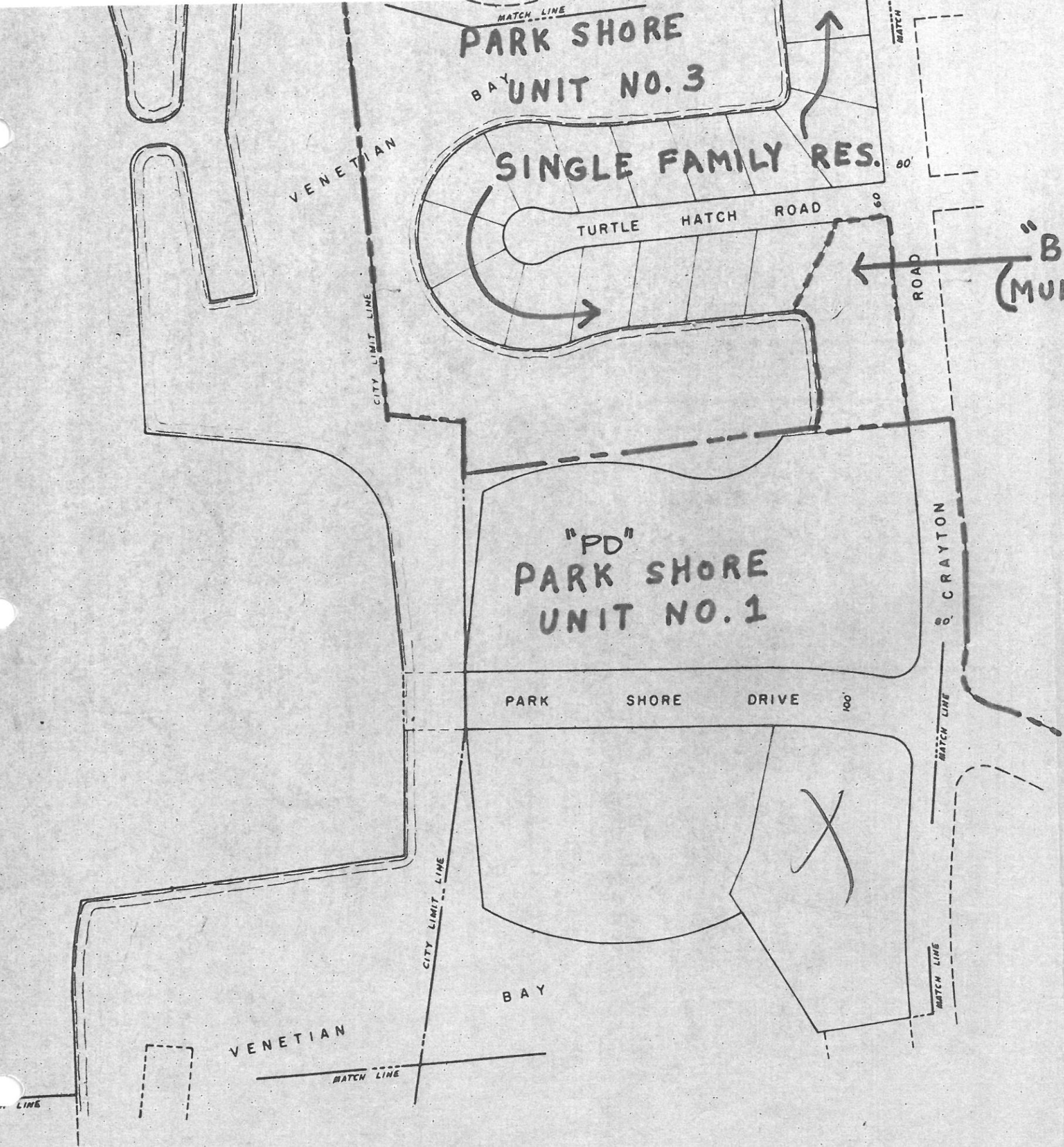

"BAY LAGOON CLUSTER"
(MULTI FAMILY RESIDEN.)

THIS ZONING ATLAS WAS
ADOPTED AS THE OFFICIAL
ZONING ATLAS BY THE CITY
COUNCIL, CITY OF NAPLES

BY: *Harry E. O. Heineman*
HARRY E. O. HEINEMAN
MAYOR

ATTEST: *Janet Davis*
JANET DAVIS
CITY CLERK

SEAL:

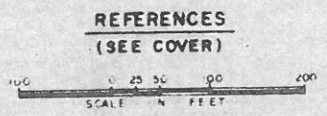

REFERENCES
(SEE COVER)
PREPARED BY:
WILSON MILLER BARTON SOLL & PEEK, INC.
ENGINEERS & SURVEYORS NAPLES, FLORIDA



SHEET 2 of 7

53

DATE
OCTOBER 19, 1977

ORD. NO.
2792

SINGLE FAMILY
RESIDENTIAL

HIGHWAY COMM.

WESTERLY
INLAND CLUSTER
(Multi-Family Resid.)

PARK SHORE

LAKE
UNIT NO. 3 "PD"

EASTERLY
INLAND CLUSTER

OLD TRAIL DRIVE

"APARTMENT
SITE"

(MULTI FAMILY
RESIDENTIAL)

HIGHWAY
COMMERCIAL

SINGLE FAMILY
RESIDENTIAL

"MULTI-FAMILY RES."

"HC"

U.S. 41

TAMIAMI TRAIL

CITY LIMIT LINE

ROAD

CRAYTON

PARK SHORE DRIVE

WILLOWHEAD WAYS

WILLOWHEAD DRIVE

BELAIR DRIVE

LANE

DRIVE

TRAIL DRIVE

LANE

OLD

TRAIL

BELAIR

LANE

OLD

TRAIL

BELAIR

LANE

MATCH LINE

MATCH LINE

MATCH LINE

MATCH LINE

MATCH LINE

MATCH LINE

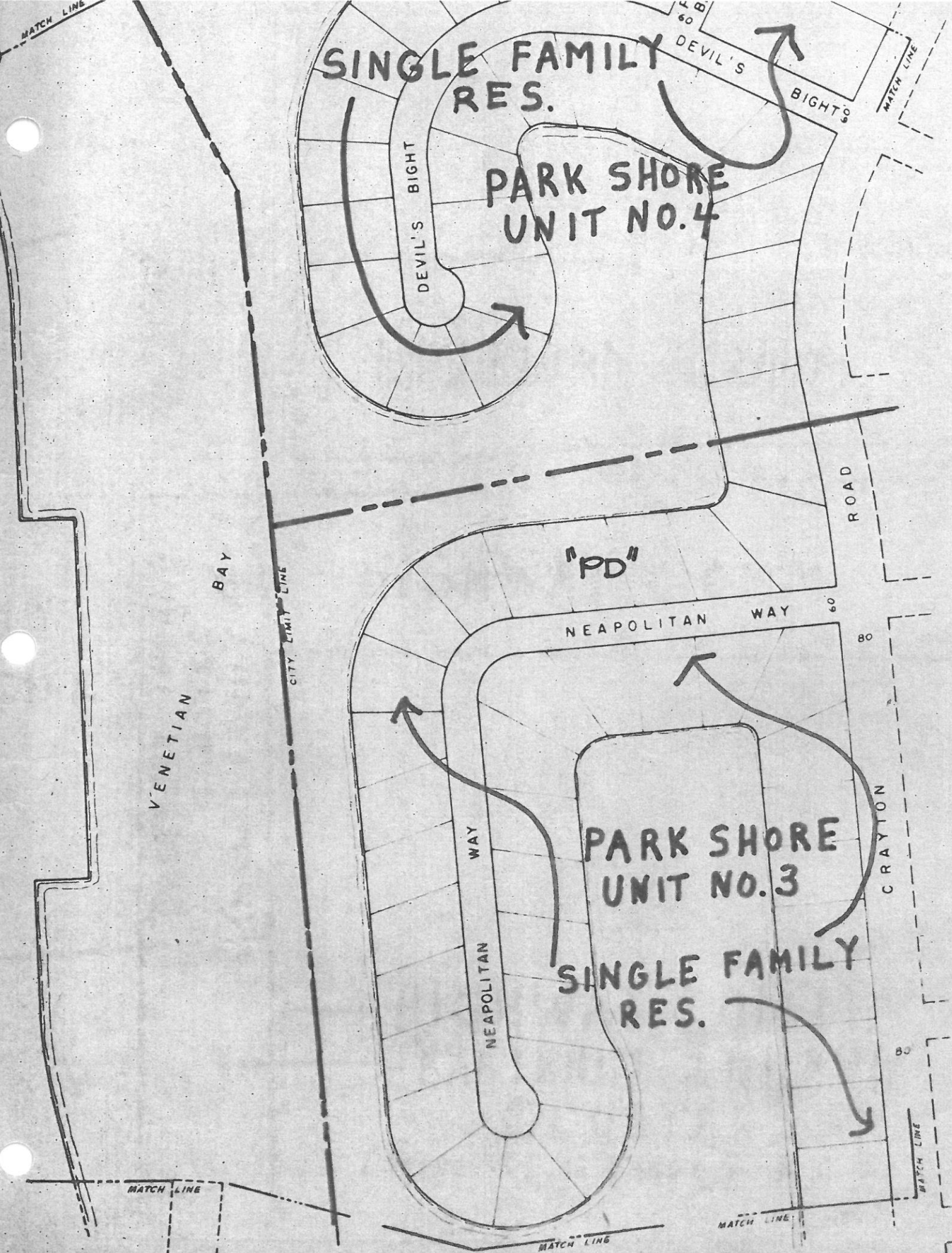

56

THIS ZONING ATLAS WAS ADOPTED AS THE OFFICIAL ZONING ATLAS BY THE CITY COUNCIL, CITY OF NAPLES.

BY: *Harry E. O. Heineman*
 HARRY E. O. HEINEMAN
 MAYOR

ATTEST: *Janet L. Davis*
 JANET DAVIS
 CITY CLERK

SEAL:

REFERENCES
 (SEE COVER)

WILSON MILLER BARTON SOLL & PEER, INC.
 ENGINEERS & SURVEYORS
 NAPLES, FLORIDA



SHEET 4 of 7

DEC 1975

55

DATE
 OCTOBER 19, 1977

ORD. NO.
 2792

53

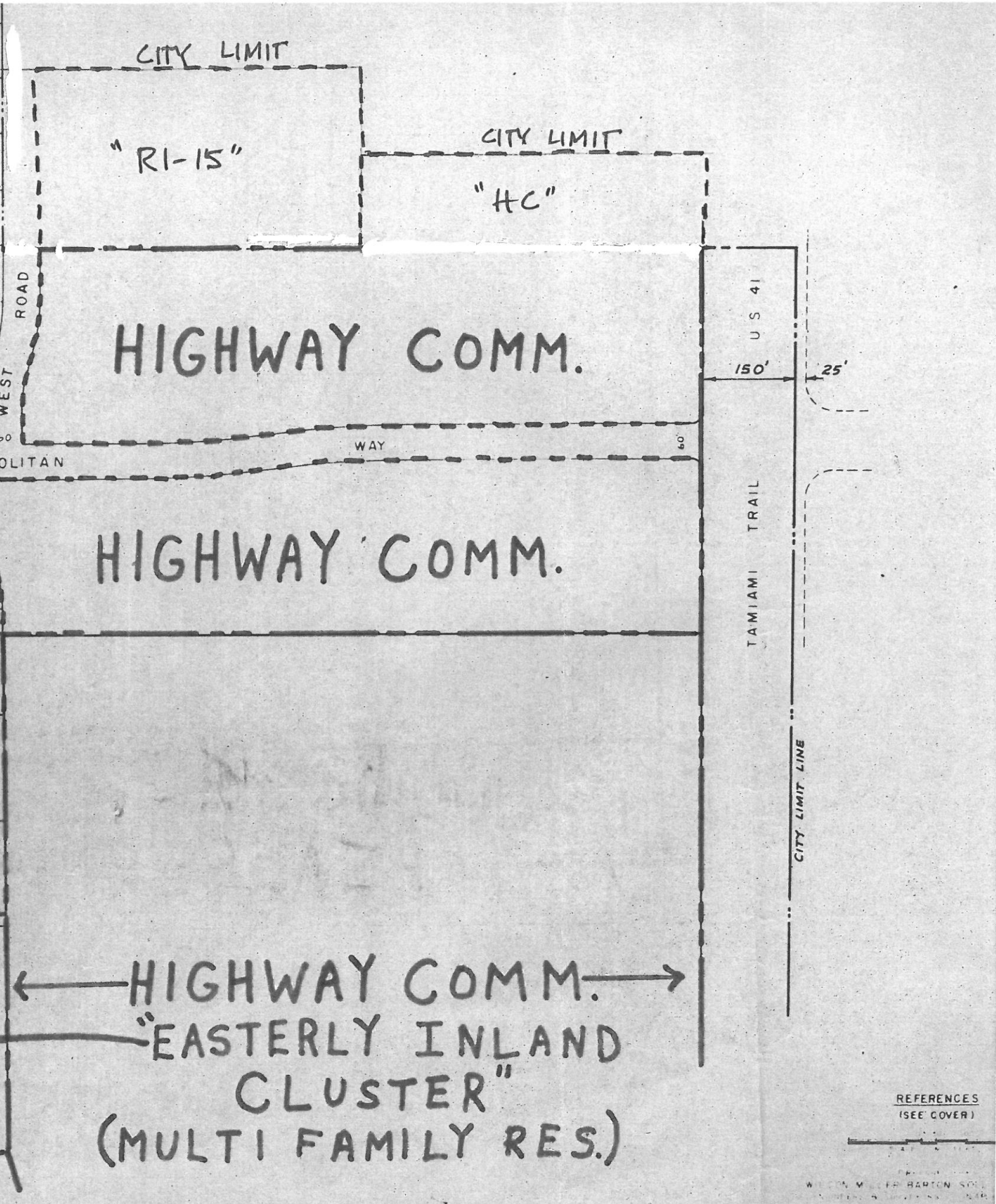
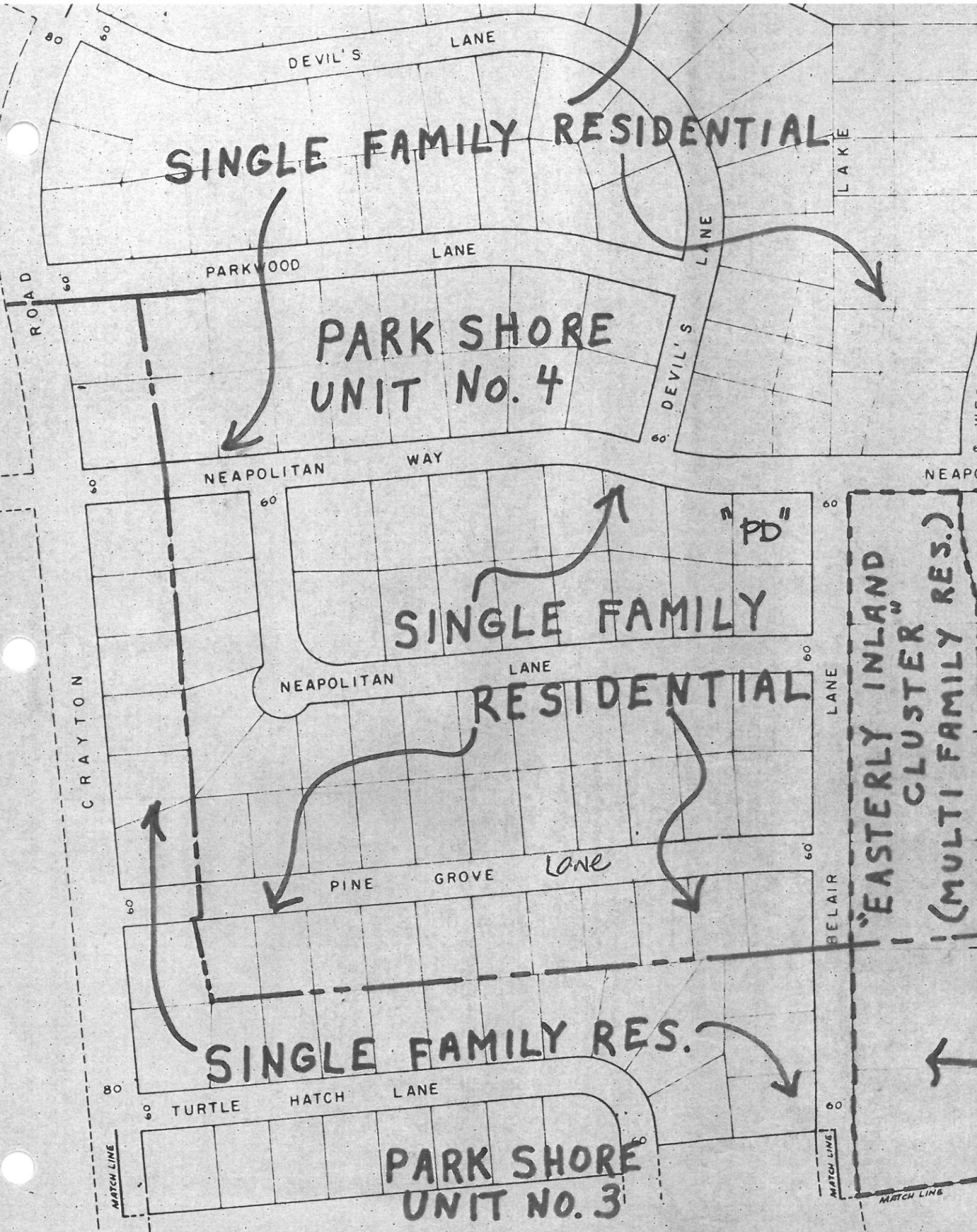

REFERENCES
(SEE COVER)

WILLIAM MILLER BARTON SOIL
ENGINEERS & ARCHITECTS

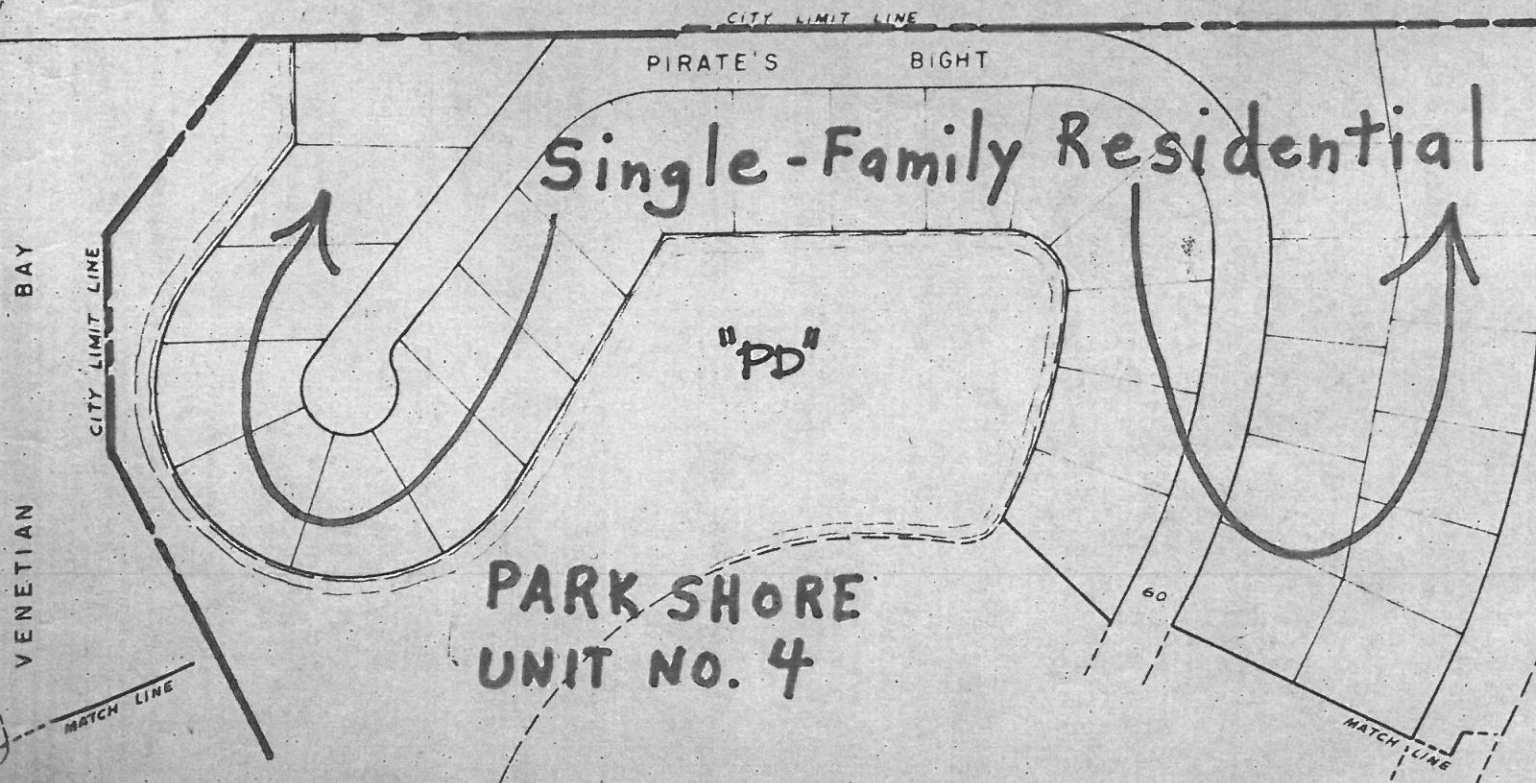

58 THIS ZONING ATLAS WAS ADOPTED AS THE OFFICIAL ZONING ATLAS BY THE CITY COUNCIL, CITY OF NAPLES.

BY: *Harry E. O. Heineman*
 HARRY E. O. HEINEMAN
 MAYOR

ATTEST: *Janet L. Davis*
 JANET DAVIS
 CITY CLERK

SEAL:

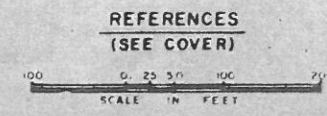

SHEET 6 of 7

PREPARED BY
 WILSON MILLER BARTON SOLL & PEEK, INC.
 ENGINEERS & SURVEYORS NAPLES, FLORIDA

DEC. 1975
 57

DATE
 OCTOBER 19, 1977

ORD. NO.
 2792

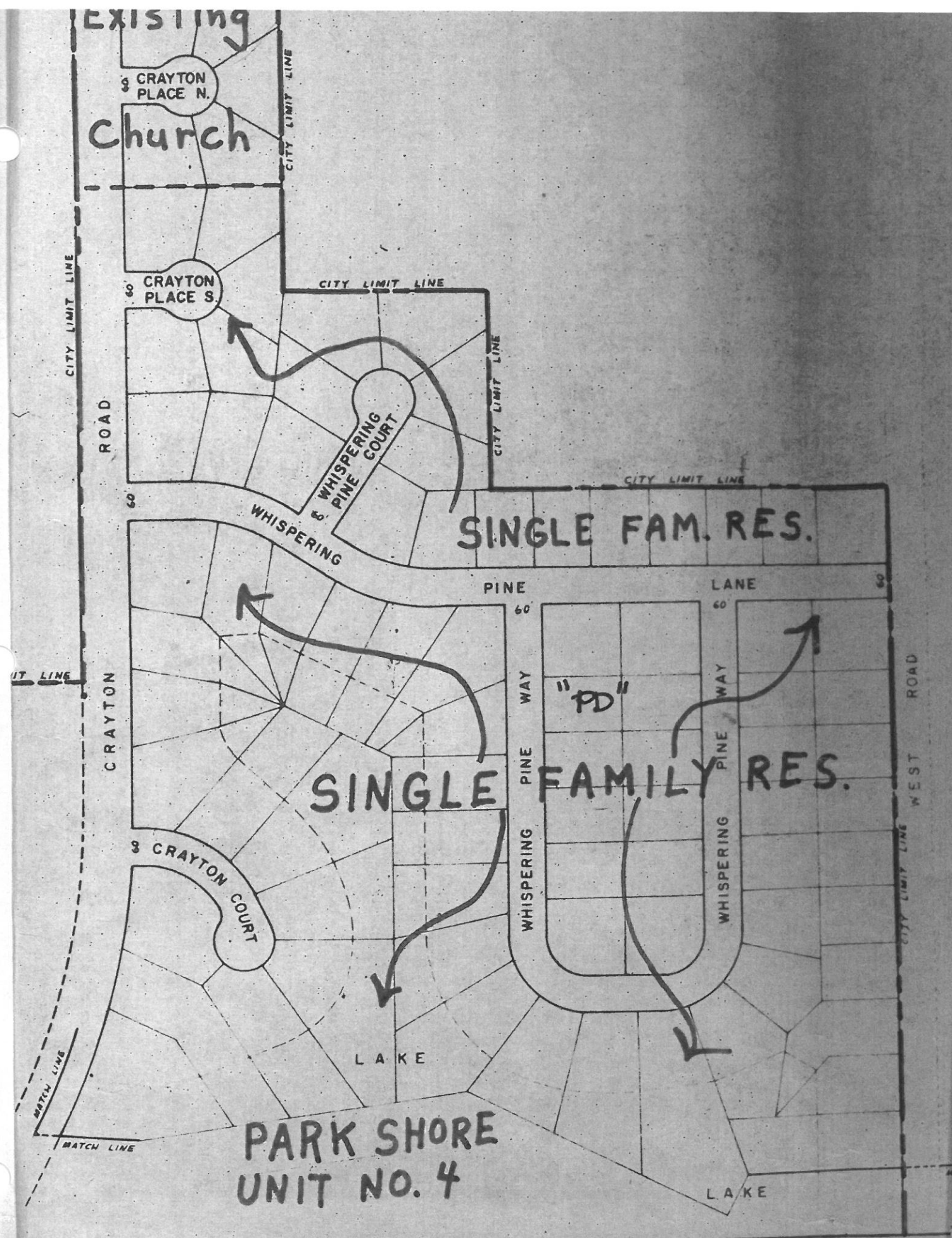

THIS ZONING ATLAS WAS ADOPTED AS THE OFFICIAL ZONING ATLAS BY THE CITY COUNCIL, CITY OF NAPLES.

BY: *Harry E. O. Heineman*
 HARRY E. O. HEINEMAN
 MAYOR

ATTEST: *Janet L. Davis*
 JANET DAVIS
 CITY CLERK

SEAL:

REFERENCES
 (SEE COVER)



SHEET 7 of 7

58

DATE
 OCTOBER 19, 1977

ORD. NO.
 2792