

GULF OF MEXICO



ZONE A8 (EL 9)
CORPORATE LIMITS

ELEVATION REFERENCE MARKS

REFERENCE MARK	ELEVATION (FT. NGVD)	DESCRIPTION OF LOCATION
RM14	9.8	At the intersection of the centerlines of Second Avenue South and Fourth Street. Established by U.S. Coast and Geodetic Survey or Florida Geological Survey.
RM15	5.9	At the intersection of the centerlines of Seventh Avenue South and Second Street. Established by U.S. Coast and Geodetic Survey or Florida Geological Survey.
RM18	3.1	At the intersection of the centerlines of Eighth Avenue South and Eleventh Street. Established by U.S. Coast and Geodetic Survey or Florida Geological Survey.
RM19	6.8	At the intersection of the centerlines of First Street (Gulf Shore Boulevard) and Twelfth Avenue South. Established by U.S. Coast and Geodetic Survey or Florida Geological Survey.
RM20	4.7	At the intersection of the centerlines of Sixteenth Avenue South and Second Street. Established by U.S. Coast and Geodetic Survey or Florida Geological Survey.
RM21	4.7	At the intersection of the centerlines of Eleventh Avenue South and Sixth Street. Established by U.S. Coast and Geodetic Survey or Florida Geological Survey.
RM22	3.3	At the intersection of the centerlines of Twelfth Avenue South and Eighth Street. Established by U.S. Coast and Geodetic Survey or Florida Geological Survey.
RM23	4.8	At the south end of Sixth Street in the south end of the circle. Established by U.S. Coast and Geodetic Survey or Florida Geological Survey.
RM24	4.5	At the intersection of the centerlines of Gordon Drive and Gallean Drive. Established by U.S. Coast and Geodetic Survey or Florida Geological Survey.
RM25	7.7	At the intersection of the centerlines of Kings Town Drive and Lantern Lane. Established by U.S. Coast and Geodetic Survey or Florida Geological Survey.
RM26	3.7	At the intersection of the centerlines of Thirty-third Avenue South and Gordon Drive. Established by U.S. Coast and Geodetic Survey or Florida Geological Survey.
RM27	5.0	North from Kings Town Drive to the fork in the road before Gallean Drive; at the intersection of the fork on Treasure Lane. Established by U.S. Coast and Geodetic Survey or Florida Geological Survey.

KEY TO MAP

500-Year Flood Boundary
100-Year Flood Boundary
Zone Designations* With Date of Identification e.g., 12/2/74
100-Year Flood Boundary
500-Year Flood Boundary

Base Flood Elevation Line With Elevation In Feet**

Base Flood Elevation In Feet Where Uniform Within Zone**

Elevation Reference Mark

River Mile

**Referenced to the National Geodetic Vertical Datum of 1929

***EXPLANATION OF ZONE DESIGNATIONS**

ZONE **EXPLANATION**

A Areas of 100-year flood; base flood elevations and flood hazard factors not determined.

A0 Areas of 100-year shallow flooding where depths are between one (1) and three (3) feet; average depths of inundation are shown, but no flood hazard factors are determined.

AH Areas of 100-year shallow flooding where depths are between one (1) and three (3) feet; base flood elevations are shown, but no flood hazard factors are determined.

A1-A30 Areas of 100-year flood; base flood elevations and flood hazard factors determined.

A99 Areas of 100-year flood to be protected by flood protection system under construction; base flood elevations and flood hazard factors not determined.

B Areas between limits of the 100-year flood and 500-year flood; or certain areas subject to 100-year flooding with average depths less than one (1) foot or where the contributing drainage area is less than one square mile; or areas protected by levees from the base flood. (Medium shading)

C Areas of minimal flooding. (No shading)

D Areas of undetermined, but possible, flood hazards.

V Areas of 100-year coastal flood with velocity (wave action); base flood elevations and flood hazard factors not determined.

V1-V30 Areas of 100-year coastal flood with velocity (wave action); base flood elevations and flood hazard factors determined.

NOTES TO USER

Certain areas not in the special flood hazard areas (Zones A and V) may be protected by flood control structures.

This map is for flood insurance purposes only; it does not necessarily show all areas subject to flooding in the community or all planimetric features outside special flood hazard areas.

For adjoining map panels, see separately printed Index To Map Panel.

INITIAL IDENTIFICATION:
MAY 5, 1970

FLOOD HAZARD BOUNDARY MAP REVISIONS:
AUGUST 7, 1970

FLOOD INSURANCE RATE MAP EFFECTIVE:
JULY 2, 1971

FLOOD INSURANCE RATE MAP REVISIONS:
Map revised July 1, 1974, to change zone designations.
Map revised February 13, 1976, to reflect curvilinear flood boundaries and to add special flood hazard areas.
Map revised July 16, 1980, to change base flood elevations, zone designations, and corporate limits.

Refer to the FLOOD INSURANCE RATE MAP EFFECTIVE date shown on this map to determine when actuarial rates apply to structures in the zones where elevations or depths have been established.

To determine if flood insurance is available in this community, contact your insurance agent, or call the National Flood Insurance Program, at (800) 638-6620, or (800) 424-8872.

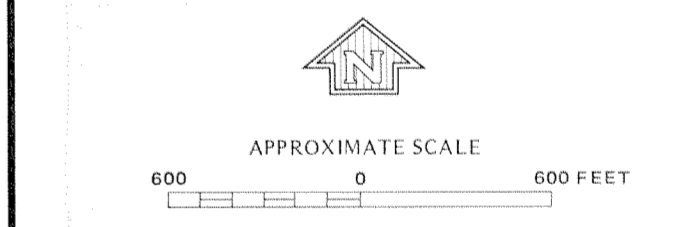

NATIONAL FLOOD INSURANCE PROGRAM

FIRM FLOOD INSURANCE RATE MAP

CITY OF NAPLES, FLORIDA
COLLIER COUNTY

PANEL 3 OF 4
(SEE MAP INDEX FOR PANELS NOT PRINTED)

COMMUNITY-PANEL NUMBER
125130 0003 B

MAP REVISED:
JULY 16, 1980

U.S. DEPARTMENT OF HOUSING AND URBAN DEVELOPMENT
FEDERAL INSURANCE ADMINISTRATION