



KEY TO MAP

300-Year Flood Boundary	—	ZONE B
100-Year Flood Boundary	—	ZONE A1 DATE
Zone Designations* With Date of Identification	—	ZONE A DATE
100-Year Flood Boundary	—	ZONE B
300-Year Flood Boundary	—	ZONE B
Base Flood Elevation Line With Elevation In Feet**	— 573 —	(EL 987)
Base Flood Elevation In Feet Where Uniform Within Zone**	—	(EL 987)
Elevation Reference Mark	RM7, x	M1.5
River Mile	—	M1.5

**Referenced to the National Geodetic Vertical Datum of 1929

ELEVATION REFERENCE MARKS

REFERENCE MARK	ELEVATION (FT. NGVD)	DESCRIPTION OF LOCATION
RM1	12.1	At the intersection of the centerlines of Tenth Street and Twenty-eighth Avenue North. Established by U.S. Coast and Geodetic Survey or Florida Geological Survey.
RM2	9.1	At the intersection of the centerline of Fourteenth Street and Twenty-second Avenue North. Established by U.S. Coast and Geodetic Survey or Florida Geological Survey.
RM3	5.9	At the intersection of the centerlines of Windward Way and Law Line Drive. Established by U.S. Coast and Geodetic Survey or Florida Geological Survey.
RM4	8.9	At the intersection of the centerlines of Mooring Line Drive and Crayton Road. Established by U.S. Coast and Geodetic Survey or Florida Geological Survey.
RM5	5.7	At the intersection of the centerlines of Ixora Lane and Ixora Drive. Established by U.S. Coast and Geodetic Survey or Florida Geological Survey.
RM6	10.6	At the intersection of the centerline of Coral Drive and Hibiscus Road. Established by U.S. Coast and Geodetic Survey or Florida Geological Survey.
RM7	5.8	At the intersection of the centerlines of Oleander Drive and Crayton Road. Established by U.S. Coast and Geodetic Survey or Florida Geological Survey.
RM8	9.7	At the intersection of the centerlines of Seventh Street and Seventh Avenue North. Established by U.S. Coast and Geodetic Survey or Florida Geological Survey.
RM9	11.0	At the intersection of the centerlines of Twelfth Avenue North and Ninth Street (Tomami Trail). Established by U.S. Coast and Geodetic Survey or Florida Geological Survey.
RM10	6.2	At the intersection of the centerlines of Eighth Avenue North and Twelfth Street. Established by U.S. Coast and Geodetic Survey or Florida Geological Survey.
RM11	6.6	At the intersection of the centerlines of Sixth Avenue North and Tenth Street. Established by U.S. Coast and Geodetic Survey or Florida Geological Survey.
RM12	10.1	At the intersection of the centerlines of Fourth Avenue North and Third Street. Established by U.S. Coast and Geodetic Survey or Florida Geological Survey.
RM13	5.5	At the intersection of the centerlines of First Street (Gulf Shore Boulevard) and First Avenue North. Established by U.S. Coast and Geodetic Survey or Florida Geological Survey.
RM16	6.5	At the intersection of the centerlines of Second Avenue North and Seventh Street. Established by U.S. Coast and Geodetic Survey or Florida Geological Survey.
RM17	6.7	At the intersection of the centerlines of First Avenue South and Tenth Street. Established by U.S. Coast and Geodetic Survey or Florida Geological Survey.

***EXPLANATION OF ZONE DESIGNATIONS**

ZONE	EXPLANATION
A	Areas of 100-year flood; base flood elevations and flood hazard factors not determined.
AD	Areas of 100-year shallow flooding where depth are between one (1) and three (3) feet; average depth of inundation are shown, but no flood hazard factors are determined.
AH	Areas of 100-year shallow flooding where depth are between one (1) and three (3) feet; base flood elevations are shown, but no flood hazard factors are determined.
A1-A30	Areas of 100-year flood; base flood elevations and flood hazard factors not determined.
A99	Areas of 100-year flood to be protected by flood protection system under construction; base flood elevations and flood hazard factors not determined.
B	Areas between limits of the 100-year flood and 500-year flood; on certain areas subject to 100-year flooding with average depths less than one (1) foot or where the contributing drainage area is less than one square mile or areas protected by levees from the base flood (Medium shading).
C	Areas of minimal flooding (No shading).
D	Areas of undetermined, but possible, flood hazards.
V	Areas of 100-year coastal flood with velocity (wave action); base flood elevations and flood hazard factors not determined.
V1-V30	Areas of 100-year coastal flood with velocity (wave action); base flood elevations and flood hazard factors not determined.

NOTES TO USER

Certain areas not in the special flood hazard areas (Zones A and V) may be protected by flood control structures.

This map is for flood insurance purposes only; it does not necessarily show all areas subject to flooding in the community or all planimetric features outside special flood hazard areas.

For adjoining map panels, see separately printed Index To Map Panels.

INITIAL IDENTIFICATION:
MAY 5, 1970

FLOOD HAZARD BOUNDARY MAP REVISIONS:
AUGUST 7, 1970

FLOOD INSURANCE RATE MAP EFFECTIVE:
JULY 2, 1973

FLOOD INSURANCE RATE MAP REVISIONS:
Map revised July 1, 1974, to change zone designations.
Map revised February 13, 1976, to reflect curvilinear flood boundaries and to add special flood hazard areas.
Map revised July 16, 1980, to change base flood elevations, zone designations, and corporate limits.

Refer to the FLOOD INSURANCE RATE MAP EFFECTIVE date shown on this map to determine when actuarial rates apply to structures in the zones where elevations or depths have been established.

To determine if flood insurance is available in this community, contact your insurance agent, or call the National Flood Insurance Program, at (800) 638-6620, or (800) 424-8872.

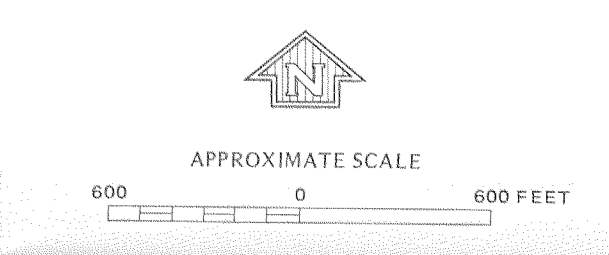

NATIONAL FLOOD INSURANCE PROGRAM

FIRM FLOOD INSURANCE RATE MAP

CITY OF NAPLES, FLORIDA
COLLIER COUNTY

PANEL 2 OF 4
(SEE MAP INDEX FOR PANELS NOT PRINTED)

COMMUNITY-PANEL NUMBER
125130 0002 B

MAP REVISED:
JULY 16, 1980

U.S. DEPARTMENT OF HOUSING AND URBAN DEVELOPMENT
FEDERAL INSURANCE ADMINISTRATION